

# FORD

# DOZER & REAR BLADES

## SERIES 705,709,710

---

## PARTS BOOK

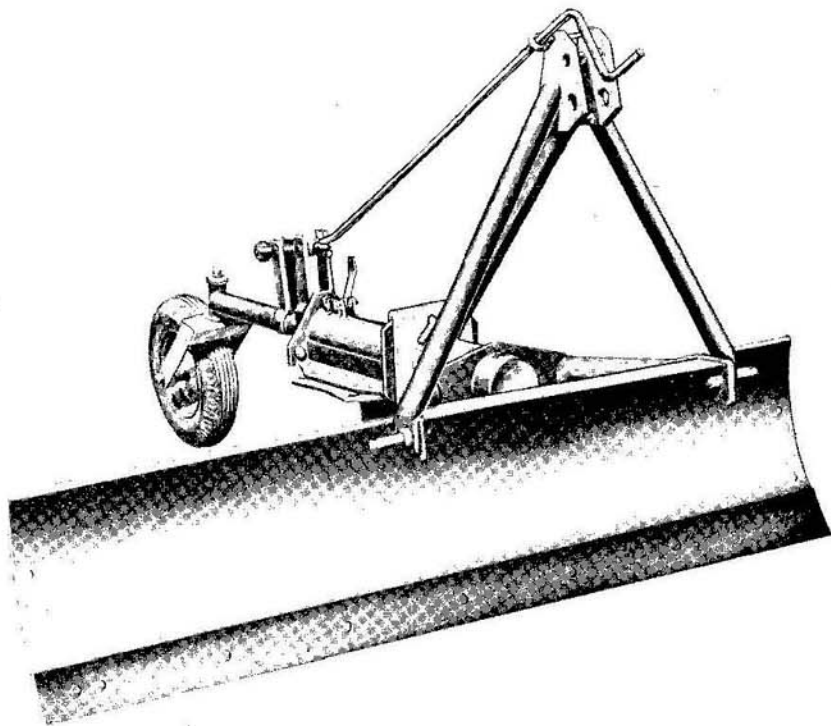

Ford Tractor Operations  
Birmingham, Michigan 48012

# BLADES

## MODEL INDEX

<u>MODEL NO.</u>	<u>DESCRIPTION</u>	<u>GROUP NO.</u>
19-1	Universal Frame - Rep'l by 19-55 (1947/52)	1-1
19-2	Angle Dozer Blade (1947/ )	3-1
19-3	Snow Plow Blade (1947/ )	3-2
19-4	"V" Snow Plow Blade (1947/53)	3-3
19-5	Utility Blade (Frame & Blade) (1947/54)	4-1,2
19-19	Gauge Wheel Attachment for 19-5 (1949/54)	5-1
19-55	Universal Frame (1952/56)	1-1
19-72	Economy Blade (1954/63)	6-1
19-80	Ford Dozer Frame (1955/ )	1-2
19-85	Ford Adjustable Rear Blade - Rep'l by 19-205 (1955/60)	7-1,2
19-86	Gauge Wheel Attachment for 19-85 (1955/60)	8-1
19-91	Hydraulic Cylinder Control Dozer Attachment for use w/Model 19-80 (1955/ )	2-1
19-92	Hydraulic Cable Control Dozer Attachment for use w/Model 19-80 (1955/ )	2-3
19-189	Gauge Wheel Attachment for 19-205 (1960/ )	8-1
19-205	Ford Adjustable Rear Blade (1960/ )	7-1,2
19-439	Ford Dozer Frame (1965/ )	1-3
19-440	Hydraulic Lift Kit use w/Model 19-439 (1965/ )	2-2
19-441	Hydraulic Cable Control Attachment use w/Model 19-439 (1965/ )	2-4

This Catalog replaces the following Parts Catalogs:

PA-2434-A	Frames & Blades Series 705,709	October, 1962
PA-2434-A1	Supplement #1 Frames & Blades	June, 1965
PA-8272	Rear Adjustable Blade Series 710	September, 1960

# BLADES

## GROUP INDEX

<u>GROUP NO.</u>	<u>DESCRIPTION</u>	<u>PAGE NO.</u>
1-1	Universal Frames (19-1,55)	6
1-2	Ford Dozer Frame (19-80)	8
1-3	Ford Dozer Frame (19-439)	9
2-1	Hydraulic Cylinder Control Attachment (19-91)	10
2-2	Hydraulic Lift Kit (19-440)	12
2-3	Hydraulic Cable Control Attachment (19-92)	14
2-4	Hydraulic Cable Control Attachment (19-441)	15
3-1	Angle Dozer Blade, Side Plates, & Skid Shoes (19-2)	17
3-2	Snow Plow Blade, Side Plates, & Skid Shoes (19-3)	19
3-3	"V" Snow Plow Blade (19-4)	21
4-1	Frame Assembly (19-5)	22
4-2	Blade Assembly (19-5)	23
5-1	Gauge Wheel Attachment (19-19)	25
6-1	Frame, Blade, & Attachments (19-72)	27
7-1	Frame & Turntable Parts (19-85,205)	29
7-2	Blade Assy, Adjustable Rear (19-85,205)	30
8-1	Gauge Wheel Attachment (19-86,189)	32
190033	Kit, Skid Shoe & Bracket	17,19,23,31
190055	Kit, Side Plate & Brace Assy.	17
190166	Kit, Release Spring	19
191166	Kit, Side Plate	19
194775	Point, Ditching	27,31
194776	Side Plates	27,31

# BLADES

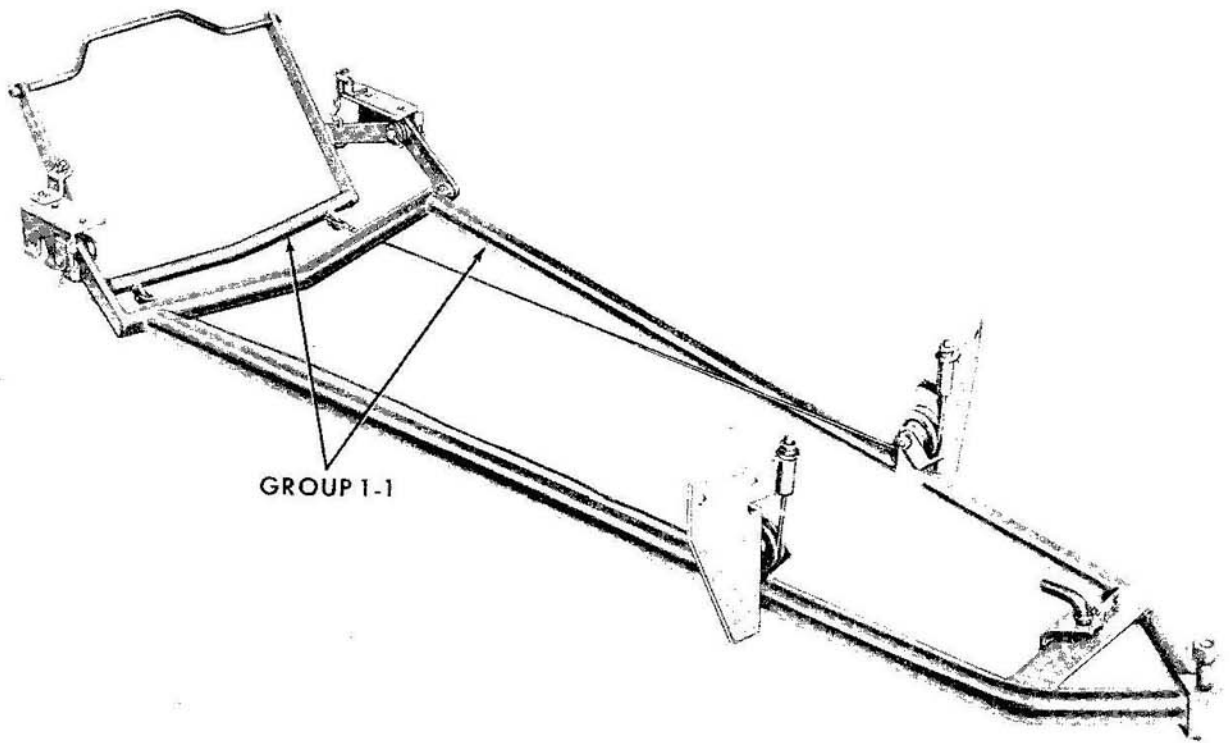

Fig. A - Dearborn Universal Frame 19-55,19-1

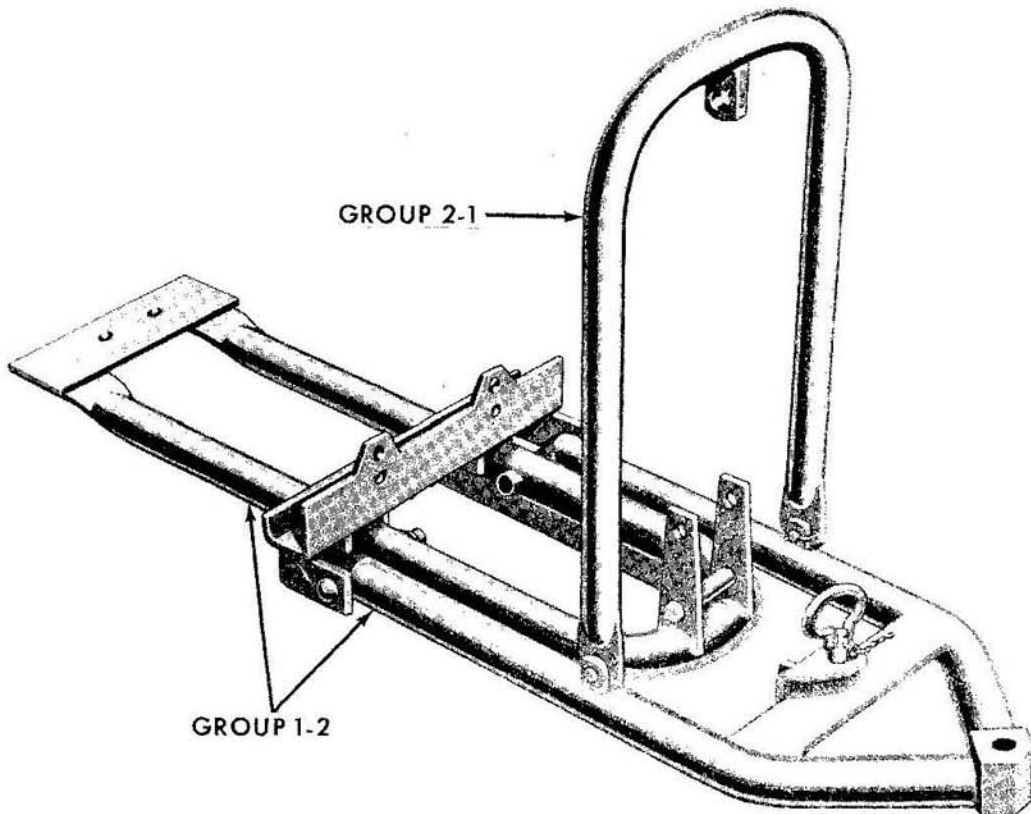

Fig. B - Ford Dozer Frame 19-80

# BLADES

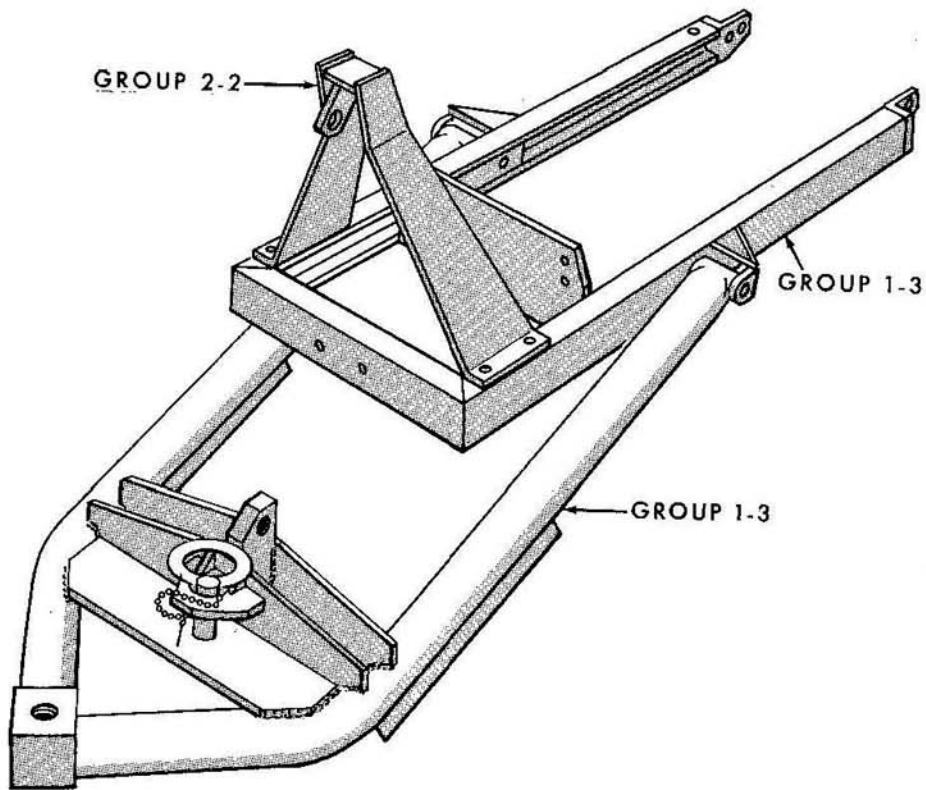

Fig. C - Ford Dozer Frame 19-439

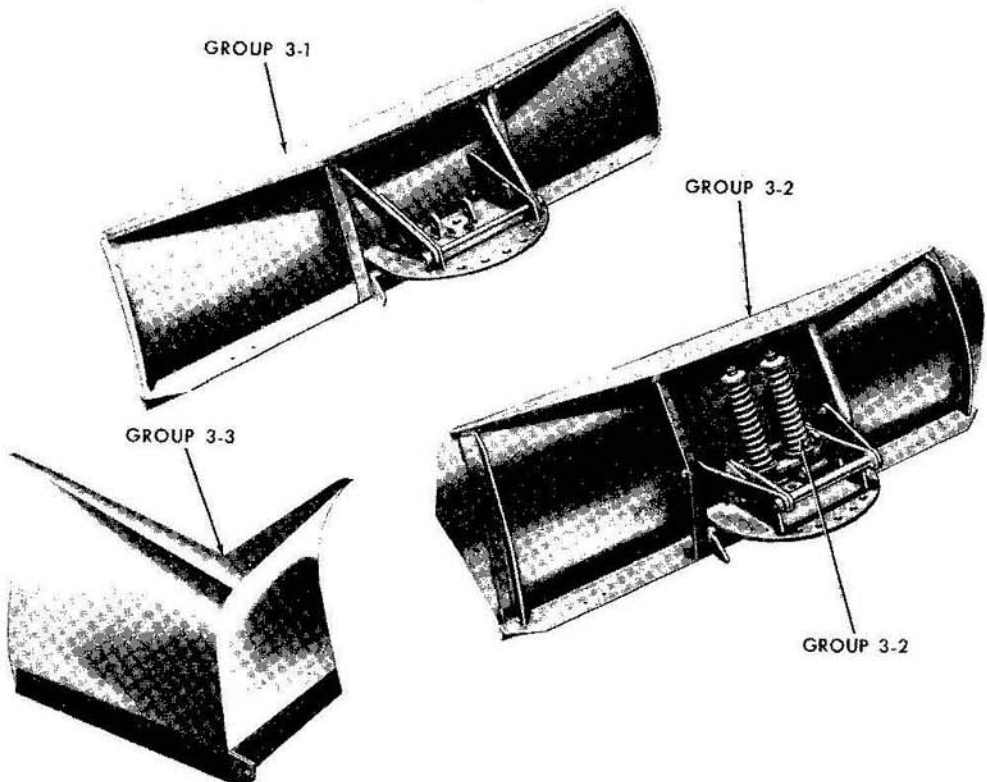

Fig. D - Dozer & Snow Plow Blades 19-2,3,4

# BLADES

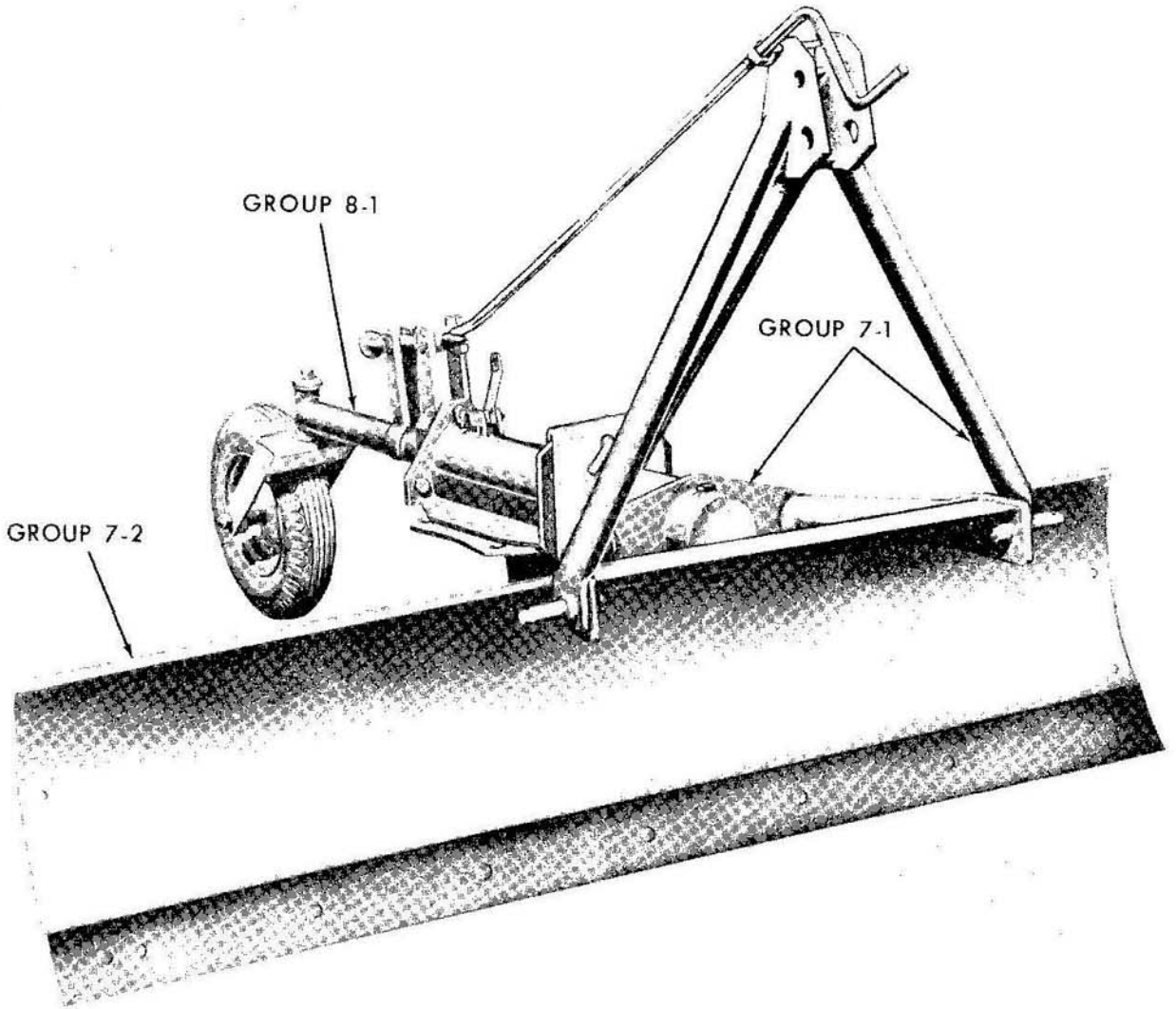

Fig. E - Ford Adjustable Rear Blade 19-205  
W/Gauge Wheel Attachment 19-189

# BLADES

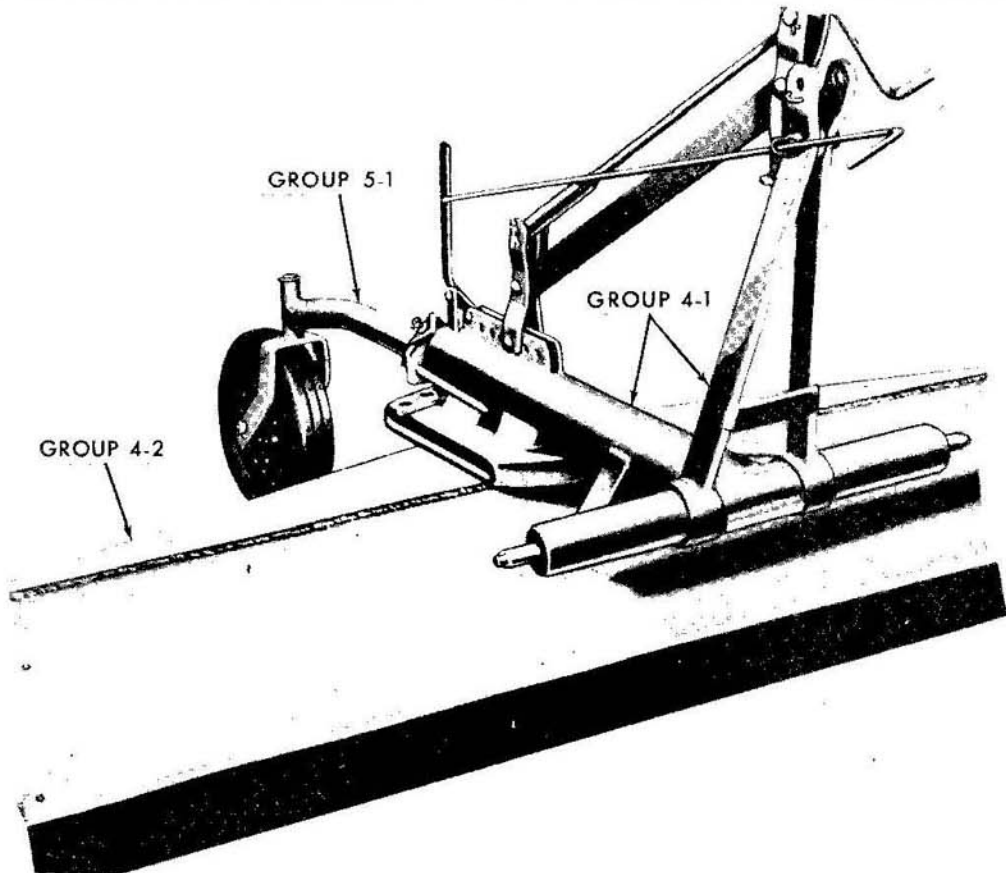

Fig. F - Dearborn Utility Blade 19-5 W/Gauge Wheel Attachment 19-19

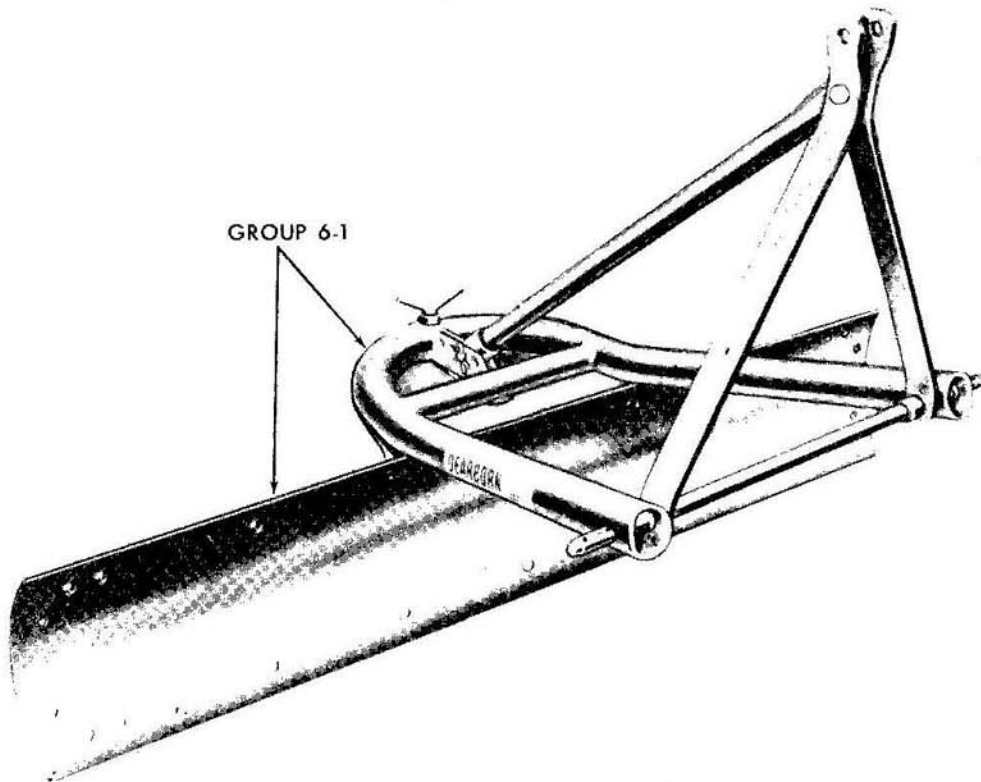

Fig. G - Economy Blade 19-72

# BLADES

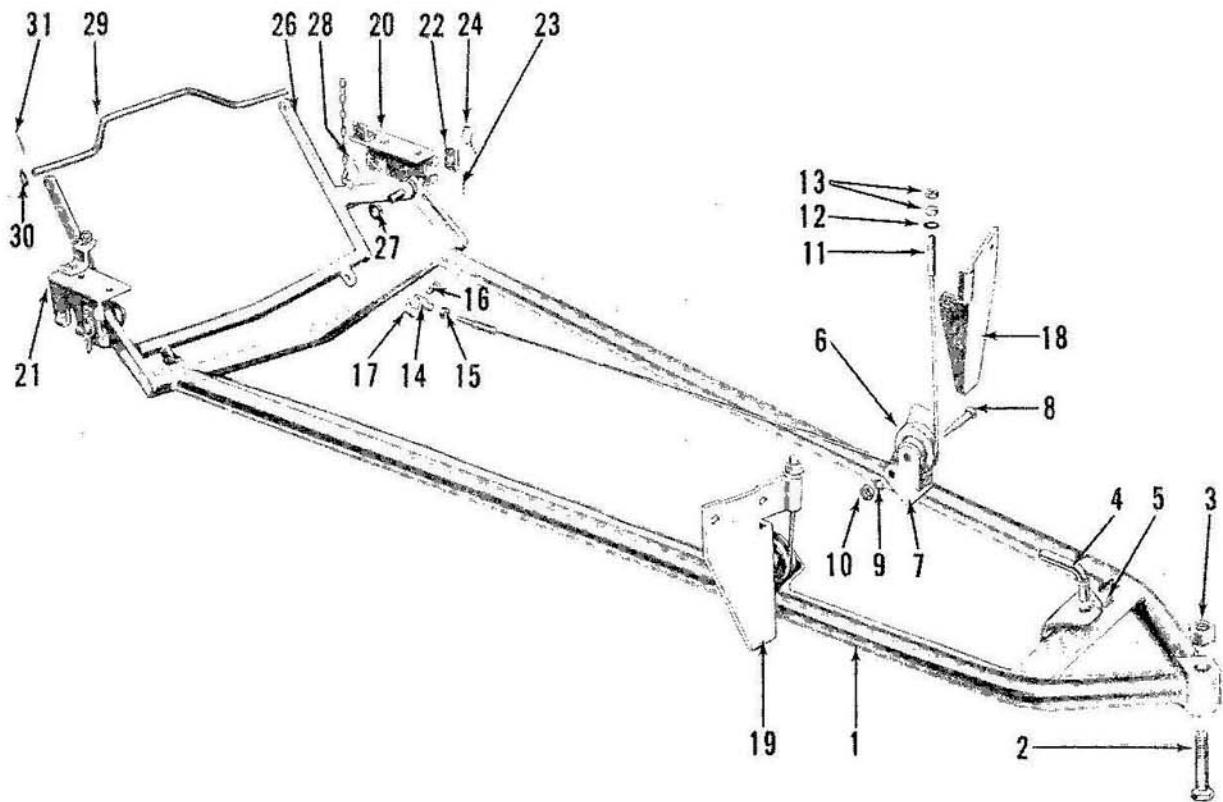

Fig. 1 - Universal Frame

FIG.	PART NO.	NAME AND DESCRIPTION	QTY. REQ.
1		<u>GROUP 1-1 UNIVERSAL FRAMES, MODELS 19-1 &amp; 55</u>	19-1 19-55
1	N.S.	FRAME ASSEMBLY . . . . .	1
2	301030-S8	BOLT, 1 - 8 x 6 Hex Hd.)	1
-	34815-S7	WASHER, 1" Lock ) Implement to Frame	1
3	34678-S8	NUT, 1 - 8 Hex )	1
4	190155	PIN ASSEMBLY, Drop . . . . .	1
		Consists of Pin Plus:	
5	190157	CHAIN, Drop Pin . . . . .	1
-	72035-S8	PIN, 3/16 x 1-1/2 Cotter . . . . .	2
6	190124	PULLEY, Cable . . . . .	2
7	190122	GUARD, Pulley . . . . .	2
8	190123	SHAFT, Pulley . . . . .	2
9	34809-S36	WASHER, 1/2 Lock )	2
10	33846-S8	NUT, 1/2 - 20 Hex) Pulley Shaft	2



# BLADES

FIG.	PART NO.	NAME AND DESCRIPTION	QTY. REQ.
1		<u>GROUP 1-1 UNIVERSAL FRAMES MODELS 19-1 &amp; 55</u> (CONT'D)	19-1 19-55
11	194024	CABLE ASSY, 84-7/8 Long (19-55 Only) . . . . .	2
11	190151	CABLE ASSY, 82 Long (19-1 Only) . . . . .	2
12	44744-S8	WASHER, 5/8 Flat ) Cable to Front Bracket	2
13	33947-S8	NUT, 5/8 - 18 Hex Jam)	4
14	97013-S36	YOKE, End 3/8 - 24 . . . . .	2
15	33800-S36	NUT, 3/8 - 24 Hex - End Yoke . . . . .	2
16	73941-S8	PIN, 3/8 - 1-5/16 Clevis) Yoke to Lift Quadrant	2
17	72035-S8	PIN, 1/8 x 1-1/2 Cotter )	2
18	190121	BRACKET, Axle-Front Left . . . . .	1
19	190162	BRACKET, Axle-Front Right . . . . .	1
20	194011	BRACKET ASSY, Axle-Rear Left . . . . .	1
21	194035	BRACKET ASSY, Axle-Rear Right . . . . .	1
22	190159	BLOCK, Retainer . . . . .	2
23	72037-S8	PIN, 3/16 x 1 Cotter - Chain . . . . .	2
24	2N-608	LINK PIN & LOCKING RING . . . . .	2
26	194283	QUADRANT ASSY, Lift . . . . .	1
27	44756-S8	WASHER, 1" Flat )	2
28	72073-S8	PIN, 3/16 x 1-1/2 Cotter) Quadrant to Frame	2
29	190126	BAR, Cross . . . . .	1
30	44752-S8	WASHER, 7/8 Flat . . . . .	2
31	72073-S8	PIN, 3/16 x 1-1/2 Cotter . . . . .	2

# BLADES

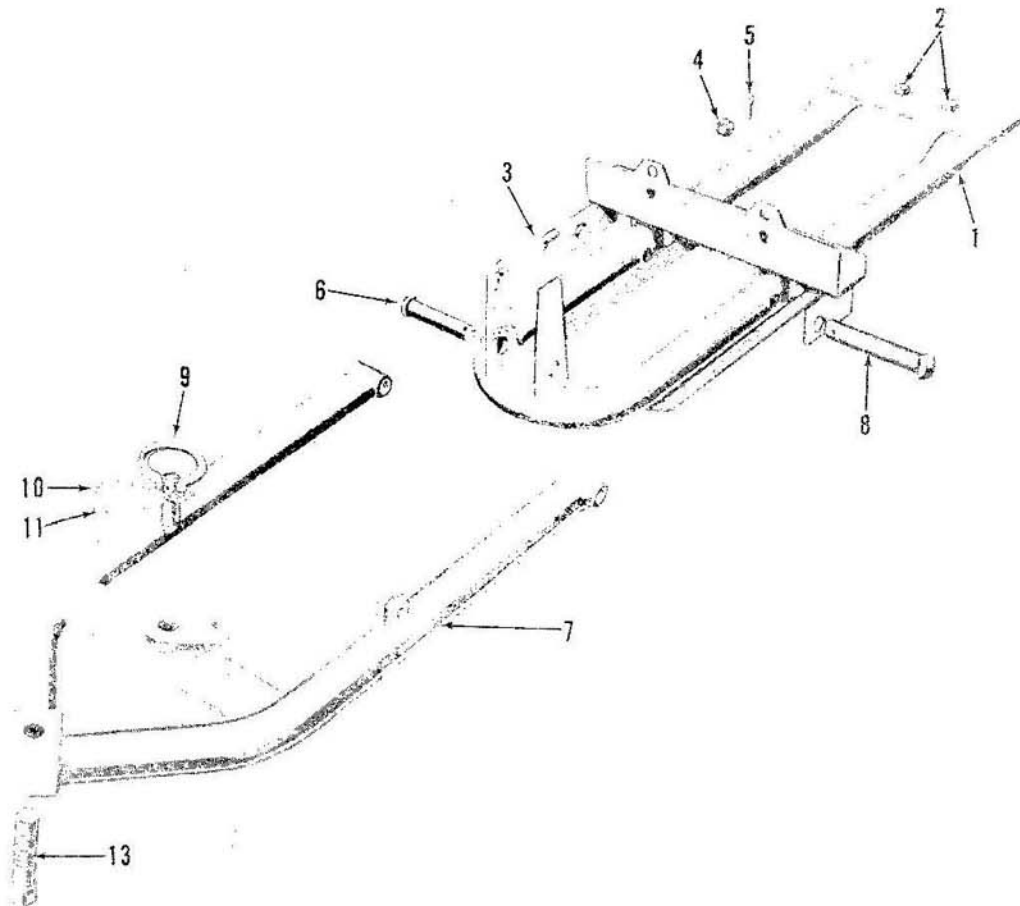

Fig. 2 - Dozer Frame - 19-80

FIG.	PART NO.	NAME AND DESCRIPTION	QTY. REQ.
2		<u>GROUP 1-2 - FORD DOZER FRAME, MODEL 19-80</u>	<u>19-80</u>
1	194769	FRAME, Rear . . . . .	1
2	373217-S8	BOLT, 5/8 - 11 x 1-1/2 Hex Drld. Hd.)	2
3	107557	BOLT, 3/4 - 16 x 2 Hex Hd. Drld. )	2
4	34675-S8	NUT, 3/4 -16 Hex ) Frame to Tractor	2
5	72071-S8	PIN, 1/8 x 1-1/2 Cotter )	2
6	196347	PIN, 1 x 4-3/4 Clevis )	1
-	72071-S8	PIN, 1/8 x 1-1/2 Cotter) Cylinder to Frame	1
7	194663	ARM ASSY, Lift . . . . .	1
8	199147	PIN, 1 x 6-5/8 Clevis )	2
-	72075-S8	PIN, 1/4 x 1-1/2 Cotter) Arm to Frame	2
9	195367	PIN ASSY, Drop . . . . .	1
10	190157	CHAIN, Drop . . . . .	1
11	72073-S8	PIN, 3/16 x 1-1/2 Cotter - Pin & Chain . . . . .	2
13	301030-S8	BOLT, 1 - 8 x 6" Hex Hd.)	1
--	34815-S7	WASHER, 1" Lock ) Blade Attaching	1
--	34678-S8	NUT, 1 - 8 Hex )	1
--	305224	DECAL, "Ford" - 1-1/2 x 4-19/32 Script . . . . .	1

# BLADES

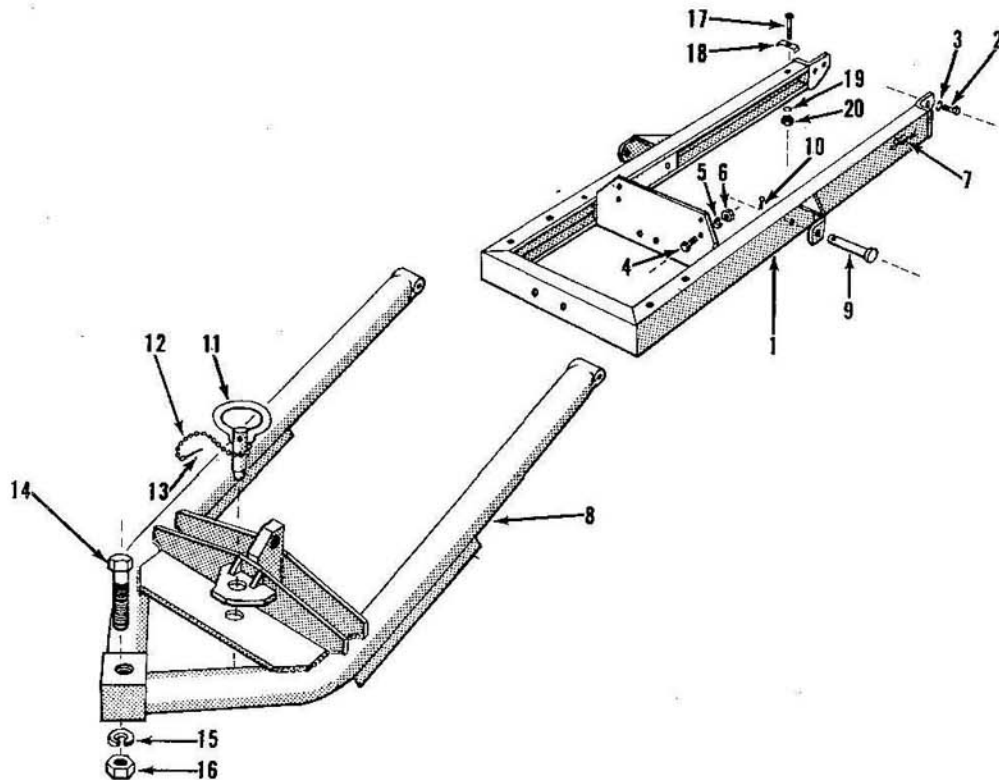

Fig. 3 - Dozer Frame - 19-439

FIG.	PART NO.	NAME AND DESCRIPTION	QTY. REQ.
3		<u>GROUP 1-3 FORD DOZER FRAME - MODEL 19-439</u>	<u>19-439</u>
1	292051	FRAME ASSY, Dozer . . . . .	1
2	304770-S36	BOLT, 3/4 - 10 x 1-1/2 Hex Hd.) Frame to Trans.	4
3	34813-S36	WASHER, 3/4 Lock ) Housing	4
4	304870-S36	BOLT, 3/4-10 x 2-1/4 Hex Hd.)	2
5	34813-S36	WASHER, 3/4 Lock ) Frame 4400 Tractor	2
6	34674-S8	NUT, 3/4 - 10 Hex )	2
-	304838-S36	BOLT, 5/8 - 11 x 2 Hex Hd.) Frame to 3100 & 4100	2
-	34811-S36	WASHER, 5/8 Lock ) All Purpose Tractors	2
7	305225	DECAL, "Ford" I.D. 1-13/16 x 5-17/32 Script . . . . .	1
8	292044	ARM ASSY, Dozer . . . . .	1
9	292064	PIN, 1 x 5.40 Clevis )	2
10	72075-S8	PIN, 1/4 x 1-1/2 Cotter) Arm to Frame	2
11	195367	PIN ASSY, Drop . . . . .	1
12	190157	CHAIN, Drop Pin . . . . .	1
13	72073-S8	PIN, 3/16 x 1-1/2 Cotter - Chain to Drop Pin & Plate	2
14	301030-S8	BOLT, 1 - 8 x 6 Hex Hd.)	1
15	34815-S7	WASHER, 1" Lock ) Equipment to Dozer Frame	1
16	34678-S8	NUT, 1 - 8 Hex )	1
17	354869-S8	BOLT, 3/8 - 16 x 2 Hex Hd.)	2
18	195211	CLAMP, Hyd. Tube Line ) Hyd. Tubes to Arm Assy.	2
19	34807-S7	WASHER, 3/8 Lock ) Part of 19-440 Hyd. Lift	2
20	33799-S8	NUT, 3/8 - 16 Hex ) Kit	2

# BLADES

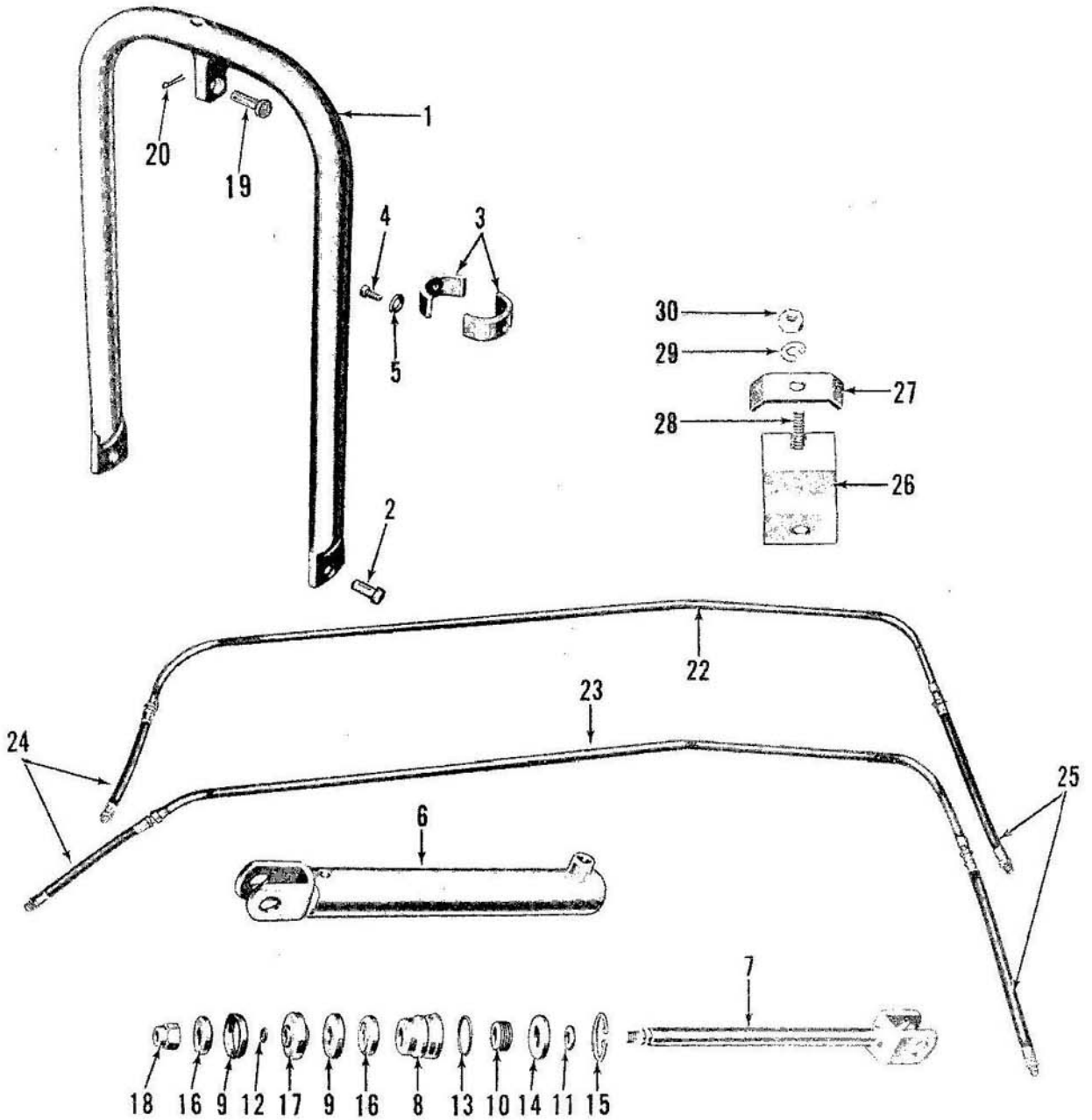

Fig. 4 - Hyd. Cylinder Control 19-91

FIG.	PART NO.	NAME AND DESCRIPTION	QTY. REQ.
4		<b>GROUP 2-1 HYDRAULIC CYLINDER CONTROL ATTACHMENT</b>	
		<b>MODEL 19-91</b>	<b>19-91</b>
1	194766	YOKE ASSY, Dozer Frame . . . . .	1
2	73975-S	PIN, 5/8 x 1-9/16 Clevis) Yoke to Dozer Lift Arm	2
-	72035-S8	PIN, 1/8 x 1 Cotter )	2
3	196009	SPACER, Cylinder . . . . .	2
4	304688-S36	BOLT, 1/2 - 13 x 1 Hex Hd.)	2
5	34809-S36	WASHER, 1/2 Lock ) Spacer to Frame	2

# BLADES

FIG.	PART NO.	NAME AND DESCRIPTION	QTY. REQ.
4		<u>GROUP 2-1 HYDRAULIC CYLINDER CONTROL ATTACHMENT</u> <u>MODEL 19-91 (CONT'D)</u>	19-91
-	194669	CYLINDER ASSEMBLY . . . . .	1
		Consists of:	
6	195675	TUBE ASSEMBLY . . . . .	1
7	292103	ROD ASSEMBLY, Piston . . . . .	1
8	195668	GLAND . . . . .	1
-	309594	KIT, Cylinder Packing Repair . . . . .	AR
		Consists of:	
9	194464	CUP, Piston (Leather) . . . . .	2
10	192128	PACKING ASSY, 1" . . . . .	1
11	195666	OIL SEAL . . . . .	1
12	87034-S94	"O"-RING, Rod . . . . .	1
13	87065-S94	"O"-RING, Cylinder - Gland Seal . . . . .	1
14	195669	CAP, Gland . . . . .	1
15	97632-S	RING, Snap (Internal) . . . . .	1
16	194466	WASHER, Piston Cup . . . . .	2
17	107962	PISTON . . . . .	1
18	55724-S8	NUT, 3/4-16 Hex Lock - Piston to Rod . . . . .	1
--	305225	DECAL, "Ford" I.D. 1-13/16 x 5-17/32 (For Service Cyls. Only) . . . . .	AR
19	196346	PIN, 1 x 2-3/8 Clevis )	1
20	72075-S8	PIN, 1/4 x 1-1/2 Cotter) Cylinder to Yoke	1
-	196009	SPACER, Dozer Cylinder . . . . .	1
22	194677	PIPE, Hydraulic . . . . .	1
23	194678	PIPE, Hydraulic . . . . .	1
24	195365	HOSE, 3/8 x 12 Coupling . . . . .	2
25	192114	HOSE, 3/8 x 16-3/4 Coupling . . . . .	2
-	192115	UNION, Adapter 3/8 . . . . .	2
--	304503	ELBOW, Street 3/8 - 18, 90° . . . . .	1
26	195363	BRACKET, Pipe . . . . .	1
27	195211	CLAMP, Hydraulic Line . . . . .	1
-	195212	J-BOLT, 3/8 - 16 )	1
28	302331-S36	BOLT, 3/8 - 16 x 1-1/2 Carr.) Clamp to Frame	1
29	34807-S36	WASHER, 3/8 Lock )	1
30	33799-S8	NUT, 3/8 - 16 Hex )	1

Kit 309594 Packings.

# BLADES

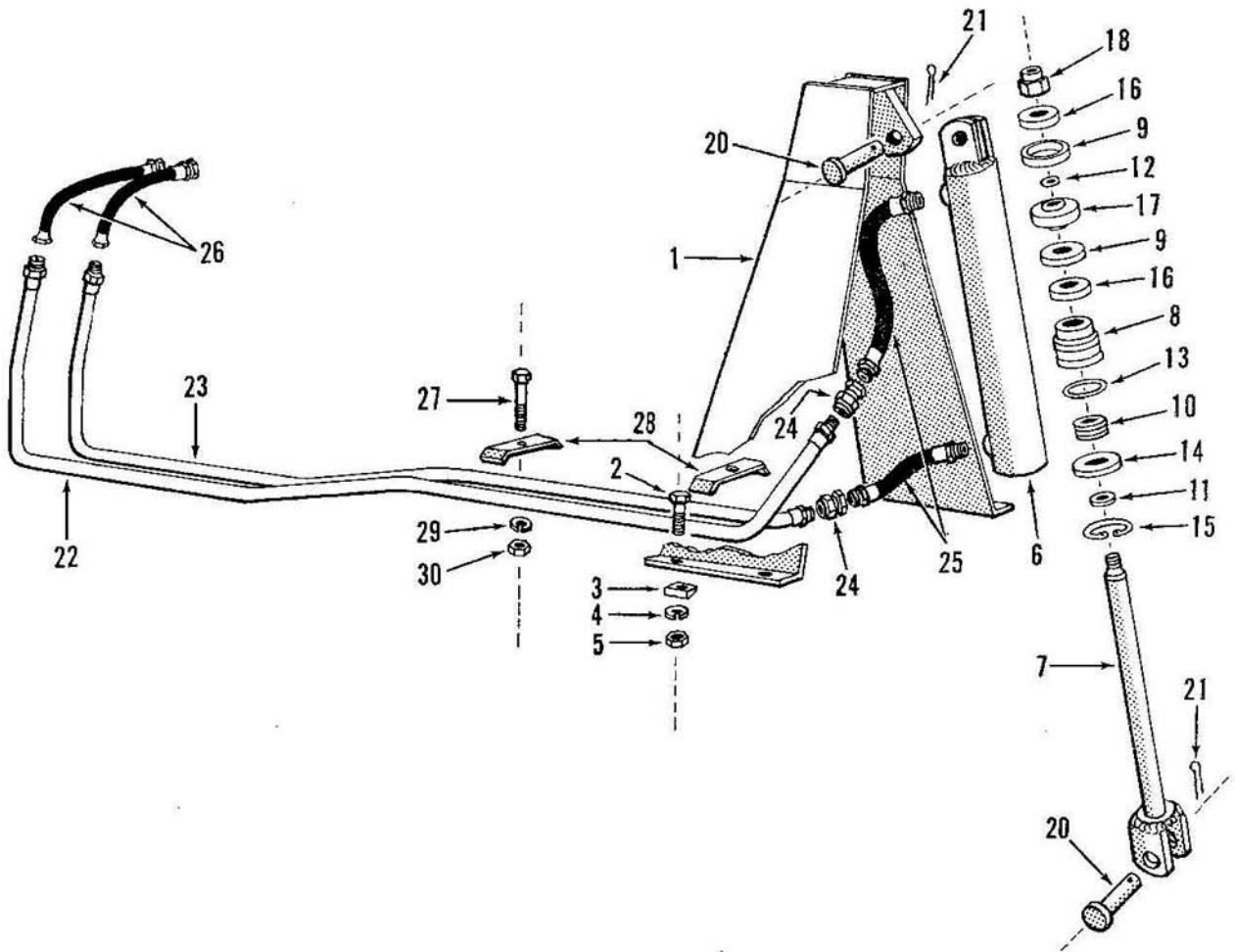

Fig. 5 - Hydraulic Lift Kit

FIG.	PART NO.	NAME AND DESCRIPTION	QTY. REQ.
<u>5</u>		<u>GROUP 2-2 HYDRAULIC LIFT KIT - MODEL 19-440</u>	<u>19-440</u>
1	292063	TOWER ASSY, Dozer . . . . .	1
2	304764-S36	BOLT, 1/2 - 13 x 1-1/2 Hex) . . . . .	4
3	198447	WASHER, Beveled ) Tower to Dozer Frame . . . . .	4
4	34809-S36	WASHER, 1/2 Lock ) . . . . .	4
5	33845-S8	NUT, 1/2 - 13 Hex Jam ) . . . . .	4
-	194669	CYLINDER ASSY, Hyd. Lift . . . . .	1
		Consists of:	
6	195675	TUBE ASSY. . . . .	1
7	292103	ROD ASSY, Piston . . . . .	1
8	195668	GLAND . . . . .	1

# BLADES

FIG.	PART NO.	NAME AND DESCRIPTION	QTY. REQ.
5		<u>GROUP 2-2 HYDRAULIC LIFT LIFT KIT - MODEL 19-440</u> (CONT'D)	19-440
-	309594	KIT, Cyl. Packing Repair . . . . .	AR
		Consists of:	
9	194464	CUP, Piston (Leather) . . . . .	2
10	192128	PACKING ASSY, 1" . . . . .	1
11	195666	OIL SEAL ASSY. . . . .	1
12	87034-S94	O-RING, .562 I.D. - Rod . . . . .	1
13	87065-S94	O-RING, 1.750 I.D. - Gland Seal . . . . .	1
14	195669	CAP, Gland . . . . .	1
15	97632-S	SNAP RING, 2-1/16 Internal . . . . .	1
16	194466	WASHER, Piston Cup . . . . .	2
17	107962	SPACER, Piston . . . . .	1
18	55724-S8	NUT, 3/4 - 16 Hex Lock - Piston to Rod . . . . .	1
--	305225	DECAL, Ford I.D. 1-13/16 x 5-17/32 Script (For Service Cyls. Only) . . . . .	AR
20	196346	PIN, 1.018 - .991 x 2.38 Clevis) Cyl. Assy. to	2
21	72075-S8	PIN, 1/4 x 1-1/2 Cotter ) Tower & Arm	2
22	292061	PIPE, Hyd. Dozer (81") . . . . .	1
23	292062	PIPE, Hyd. Dozer (76") . . . . .	1
24	192115	UNION, 3/8 Adapter . . . . .	2
25	192114	HOSE ASSY, 3/8 x 16-3/4 Hyd. Coupling . . . . .	2
26	195365	HOSE ASSY, 3/8 x 12 Hyd. Coupling . . . . .	2
27	354869-S8	BOLT, 3/8 - 16 x 2 Hex)	2
28	195211	CLAMP, Hyd. Line ) Hyd. Tubes to Dozer Frame	2
29	34807-S7	WASHER, 3/8 Lock )	2
30	33799-S8	NUT, 3/8 - 16 Hex )	2

# BLADES

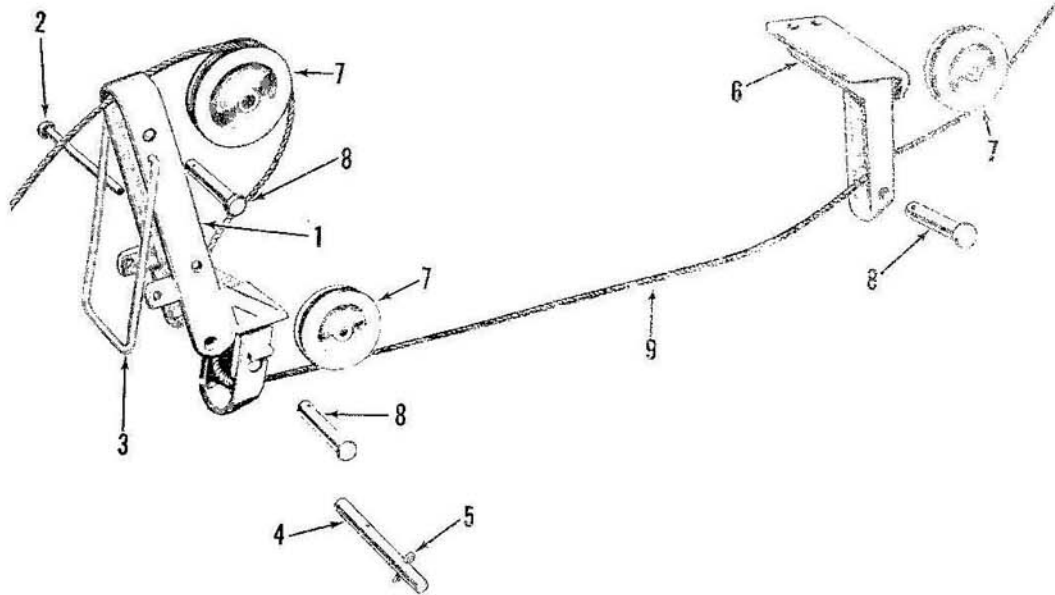

Fig. 6 - Hydraulic Cable Control Attachment 19-92

FIG.	PART NO.	NAME AND DESCRIPTION	QTY. REQ.
6		<u>GROUP 2-3 HYDRAULIC CABLE CONTROL ATTACHMENT</u> <u>MODEL 19-92 FOR MODEL 19-80</u>	19-92
1	195089	STRUT ASSY, Front Sheave . . . . .	1
2	195582	PIN, 1/2 x 4-5/8" Str. Rd.)	1
-	72035-S8	PIN, 1/8 x 1" Cotter ) Strut to Dozer Frame	2
3	195095	LINK, Blade Transport . . . . .	1
-	72035-S8	PIN, 1/8 x 1" Cotter - Link . . . . .	2
4	195096	PIN, Link Retaining . . . . .	1
5	141661	PIN, 5/64 x 1-1/2" Self Locking . . . . .	2
6	195097	BRACKET ASSY, Rear Sheave . . . . .	1
7	194772	SHEAVE, Cable . . . . .	3
8	199146	PIN, 1 x 4-1/8 Clevis)	3
-	72035-S8	PIN, 1/8 x 1" Cotter ) Sheave to Strut & Bracket	3
9	196672	CABLE ASSEMBLY . . . . .	1
-	195657 N.S.	CABLE ASSEMBLY (Replaced by 196672) . . . . .	1
		Consists of Cable Plus:	
-	195653	PLUG, Cable Lock (For 195657 Cable Only) . . . . .	2
-	195654	SLEEVE, Cable Lock (For 195657 Cable Only) . . . . .	2
-	195655	STUD, Cable (For 195657 Cable Only) . . . . .	1
-	195656	EYE, Cable . . . . .	1
-	195101	HOOK ASSEMBLY, Cable . . . . .	1
-	141661	PIN, 5/64 x 1-1/2" Self Locking - Hook to Cable	1
-	195581	PIN, 5/8 x 3.64 Str. Rd. Clevis) Cable to Tractor	1
-	72037-S8	PIN, 3/16 x 1" Cotter ) Lift Arm	2
-	N.S.	PIN, 9/16 x 1-13/16" Clevis-Procure Locally) Cable to	1
-	72035-S8	PIN, 1/8 x 1" Cotter ) Dozer Lift Arm	1
-	195370	TUBE, Cable Adjustment . . . . .	1
-	33845-S8	NUT, 1/2" - 13 Hex - Tube to Cable . . . . .	1



# BLADES

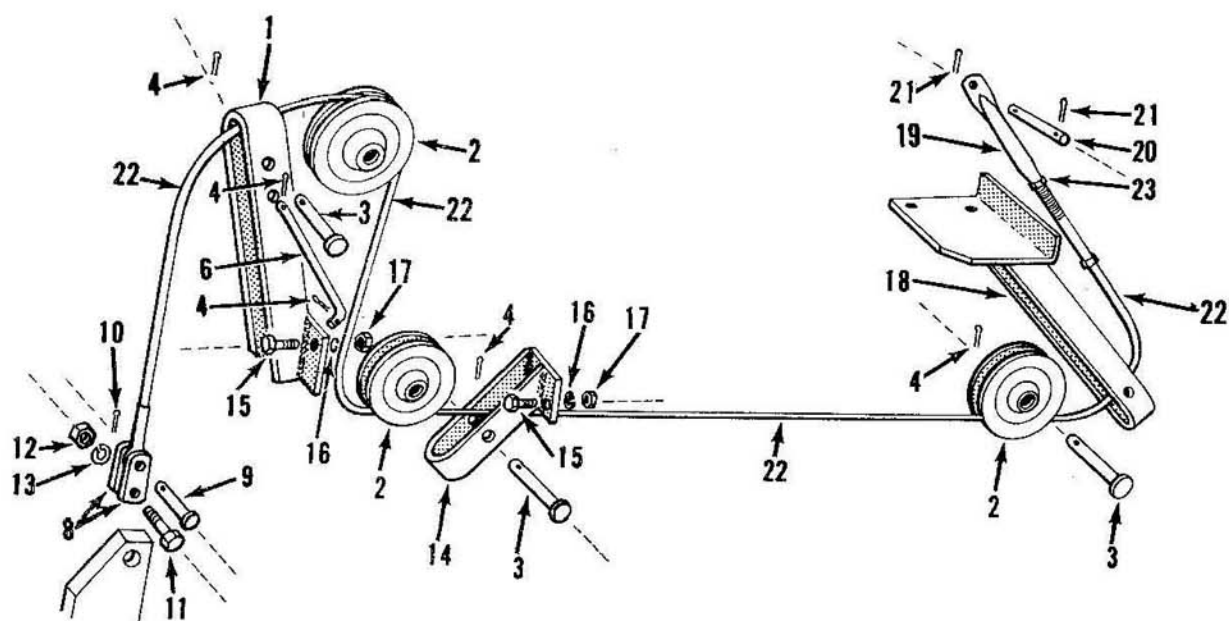

Fig. 7 - Hyd. Cable Control Attachment 19-441

FIG.	PART NO.	NAME AND DESCRIPTION	QTY. REQ.
7		<u>GROUP 2-4 HYD. CABLE CONTROL ATTACHMENT 19-441</u>	<u>19-441</u>
1	292071	HANGER ASSY, Dozer Frame . . . . .	1
2	194772	SHEAVE, Cable . . . . .	3
3	199146	PIN, Clevis 1 x 4-1/8 ) Sheave to Hanger	3
4	72075-S8	PIN, 1/4 x 1-1/2 Cotter)	3
5	292097	ROD, Dozer Transport . . . . .	1
6	72055-S8	PIN, 3/16 x 1-1/4 Cotter) Transport Rod to Hanger	1
7	141661	HAIRPIN, Cotter ) & Arm	1
8	292072	LINK, Arm Lift . . . . .	2
9	N.S.	PIN, 9/16 x 1-13/16 Clevis-Procure Locally) Cable to Arm	1
10	72035-S8	PIN, 1/8 x 1 Cotter ) Lift Link	1
11	304866-S36	BOLT, 9/16 - 12 x 2-1/4 Hex Hd.)	1
12	34810-S7	WASHER, 9/16 Lock ) Link to Dozer Lift	1
13	33847-S8	NUT, 9/16 - 12 Hex ) Arm	1
14	292074	HANGER ASSY, Front Support . . . . .	1
15	304768-S36	BOLT, 5/8 - 11 x 1-1/2 Hex Hd.)	4
16	34811-S36	WASHER, 5/8 Lock ) Hangers to Dozer	4
17	33849-S36	NUT, 5/8 - 11 Hex ) Frame	4
18	292077	BRACKET ASSY, Rear Sheave (Hanger on Brkt. 16.21 Lg.) (Attach Brkt. w/Tractor Fender Bolts)	1
18	292333	BRACKET ASSY, Rear Sheave (Hanger on Brkt. 8.80 Lg.)	1
19	195370	TUBE, Cable Adjustment . . . . .	1
20	195581	PIN, .620 x 4-3/16 Drilled) Tube to Tractor Lift	1
21	72037-S8	PIN, 3/16 x 1 Cotter ) Arm	2
22	196672	CABLE ASSY, 160.25 Lg. (Use with 292077 Brakcet)	1
22	292332	CABLE ASSY, 148.25 Lg. (Use with 292333 Bracket)	1
23	33942-S8	NUT, 1/2 - 13 Hex Jam - Tube to Cable . . . . .	1
--	N.S.	PIN, Retainer . . . . .	1
--	34806-S36	WASHER, 5/16 Lock . . . . .	1
--	33797-S36	NUT, 5/16 - 18 Hex . . . . .	1
--	141661	HAIRPIN, Cotter . . . . .	1

# BLADES

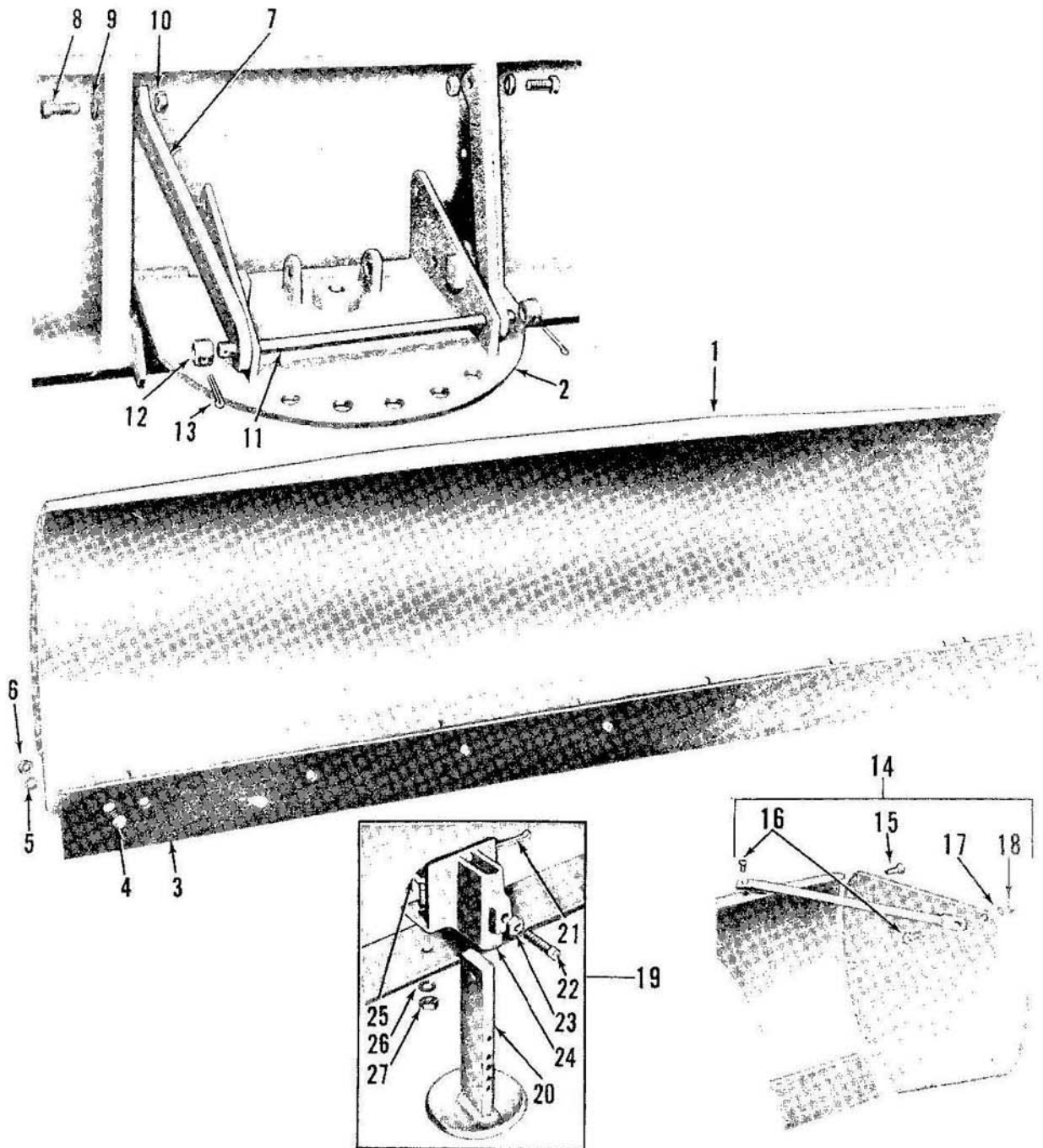

Fig. 8 - Blade Assembly W/Side Plates and Skid Shoes

# BLADES

FIG.	PART NO.	NAME AND DESCRIPTION	QTY. REQ.
8		<u>GROUP 3-1 ANGLE DOZER BLADE, SIDE PLATES &amp; SKID SHOES - MODEL 19-2</u>	19-2
-	<u>19-2</u>	<u>BLADE, Angle Dozer</u> . . . . .	AR
		Consists of Blade Plus:	
2	190021	TURNTABLE ASSEMBLY . . . . .	1
3	190200	LIP, Cutting . . . . .	1
4	300308-S8	BOLT, 1/2 - 13 x 1-1/2 Plow)	9
5	34809-S36	WASHER, 1/2 Lock ) Lip to Blade	9
6	33845-S8	NUT, 1/2 - 13 Hex )	9
7	190009	BAR, Toggle, Upper, Drld, 5/8 - 18 . . . . .	2
8	304769-S36	BOLT, 5/8 - 18 x 1-1/2 Hex Hd.)	2
9	44744-S8	WASHER, 5/8 Flat ) Bar to Blade	2
10	33850-S36	NUT, 5/8 - 18 Hex )	2
11	190005	ROD, Pivot, Toggle Bar . . . . .	1
12	190006	BUSHING, Retainer . . . . .	2
13	72111-S8	PIN, 1/4 x 2 Cotter - Bushing to Rod . . . . .	2
14	<u>190055</u>	<u>KIT, Side Plate &amp; Brace Assy. Left or Right</u> . . . . .	AR
		Consists of Plate & Braces Plus:	
15	304761-S36	BOLT, 3/8 - 24 x 1-1/2 Hex Hd.)	6
--	34807-S36	WASHER, 3/8 Lock ) Side Plates to	6
--	33800-S36	NUT, 3/8 - 24 Hex ) Blade	6
16	304685-S36	BOLT, 3/8 - 24 x 1 Hex Hd.)	4
17	34807-S36	WASHER, 3/8 Lock ) Brace to Plate & Blade	4
18	33800-S36	NUT, 3/8 - 24 Hex )	4
19	<u>190033</u>	<u>KIT, Skid Shoe &amp; Bracket</u> . . . . .	AR
		Consists of:	
20	190034	SHOE, Skid . . . . .	2
21	72057-S8	PIN, 1/4 x 1-1/4 Cotter )	2
22	91476-S34	SET SCREW, 1/2-13 x 1-1/2 Sq. Hd. Cup Pt.) Skid	2
23	33942-S8	NUT, 1/2 - 13 Hex Jam ) Shoe	2
24	190062	BRACKET, Mounting . . . . .	2
25	304765-S36	BOLT, 1/2 - 20 x 1-1/2 Hex Hd.)	4
26	34809-S36	WASHER, 1/2 Lock ) Bracket to Blade	4
27	33846-S8	NUT, 1/2 - 20 Hex )	4

# BLADES

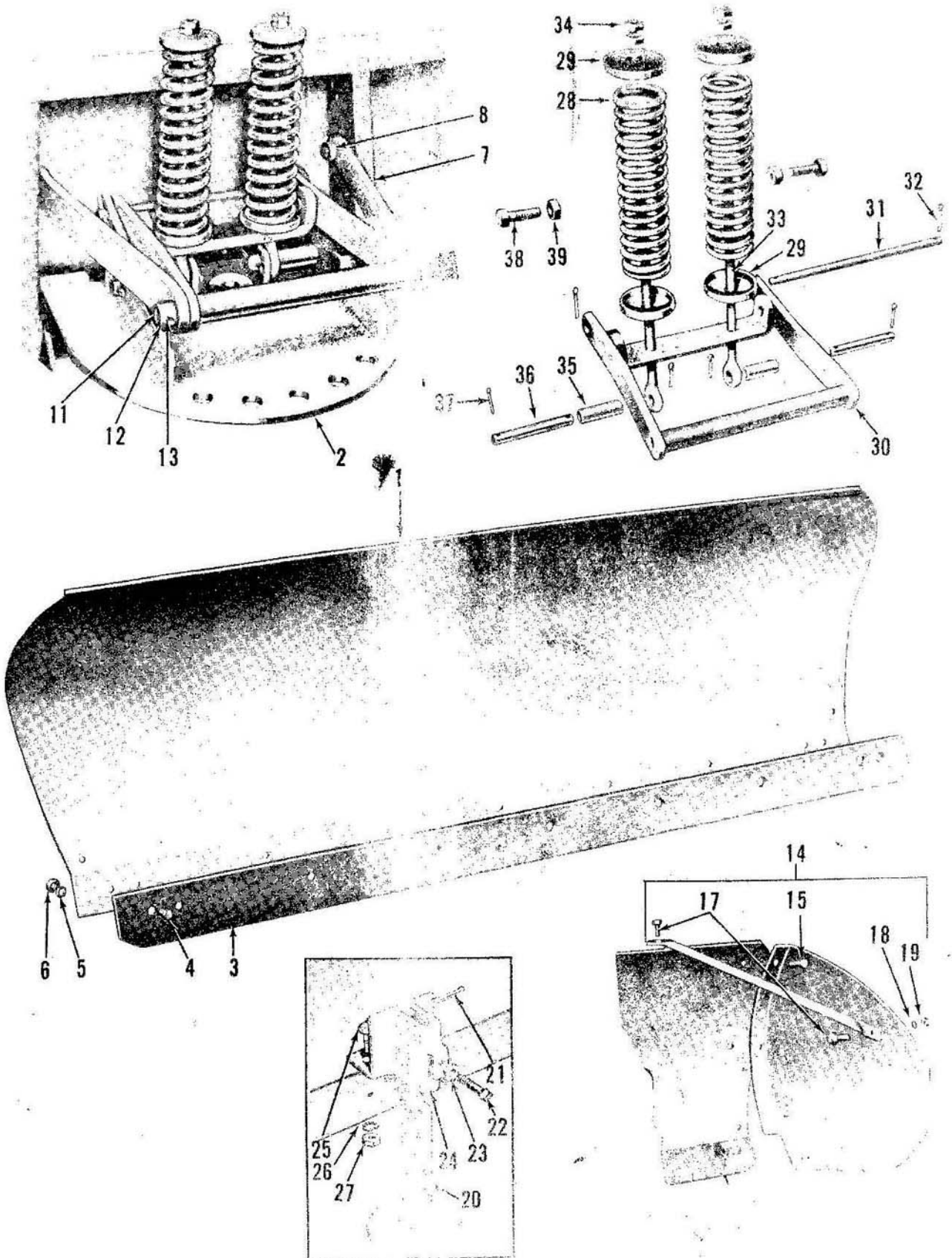

Fig. 9 - Blade, Release Spring, Plate

# BLADES

FIG.	PART NO.	NAME AND DESCRIPTION	QTY. REQ.
9		<u>GROUP 3-2 SNOW PLOW BLADE SIDE PLATES, &amp; SKID SHOES - MODEL 19-3</u>	19-3
-	<u>19-3</u>	<u>BLADE, Snow Plow</u> . . . . .	AR
		Consists of:	
1	190010	BLADE & TURNTABLE ASSEMBLY . . . . .	1
		Consists of Blade Plus:	
2	190021	TURNTABLE ASSEMBLY . . . . .	1
3	190200 <i>now ARP 390724</i>	LIP, Cutting 6' . . . . .	1
4	300308-S8	BOLT, 1/2 - 13 x 1-1/2 Plow)	9
5	34809-S36	WASHER, 1/2 Lock ) Lip to Blade	9
6	33845-S8	NUT, 1/2 - 13 Hex Jam )	9
7	190009	BAR, Toggle, Upper, Drld, 5/8 - 18 . . . . .	2
8	304769-S36	BOLT, 5/8 - 18 x 1-1/2 Hex Hd.)	2
-	44744-S8	WASHER, 5/8 Flat ) Bar to Blade	2
-	33850-S36	NUT, 5/8 - 18 Hex )	2
11	190005	ROD, Pivot, Toggle Bar . . . . .	1
12	190006	BUSHING, Retainer . . . . .	2
13	72111-S8	PIN, 1/4 x 2 Cotter - Bushing to Rod . . . . .	2
14	<u>191166</u>	<u>KIT, Side Plate &amp; Brace</u> . . . . .	AR
		Consists of Plates & Braces Plus:	
15	304761-S36	BOLT, 3/8 - 24 x 1-1/2 Hex Hd.)	6
--	34807-S36	WASHER, 3/8 Lock ) Side Plates to	6
--	33800-S36	NUT, 3/8 - 24 Hex ) Blade	6
17	304685-S36	BOLT, 3/8 - 24 x 1 Hex Hd.)	4
18	34807-S36	WASHER, 3/8 Lock ) Brace to Plate & Blade	4
19	33800-S36	NUT, 3/8 - 24 Hex )	4
--	<u>190033</u>	<u>KIT, Skid Shoe &amp; Bracket</u> . . . . .	AR
		Consists of:	
20	190034	SHOE, Skid . . . . .	2
21	72057-S8	PIN, 1/4 x 1-1/4 Cotter )	2
22	91476-S	SET SCREW, 1/2-13 x 1-1/2 Sq. Hd. Cup Pt.) Skid	2
23	33942-S8	NUT, 1/2 - 13 Hex Jam ) Shoe	2
24	190062	BRACKET, Mounting . . . . .	2
25	304765-S36	BOLT, 1/2 - 20 x 1-1/2 Hex Hd.)	4
26	34809-S36	WASHER, 1/2 Lock ) Bracket to Blade	4
27	33846-S8	NUT, 1/2 - 20 Hex )	4
--	<u>190166</u>	<u>KIT, Release Spring</u> . . . . .	1
		Consists of:	
28	190001	SPRING, Release . . . . .	2
29	190002	CAP, Spring . . . . .	4
30	190028	RELEASE ASSY, Spring . . . . .	1
31	190003	ROD, Pivot, Release . . . . .	1
32	72075-S8	PIN, 1/4 x 1-1/2 Cotter - Pivot Rod . . . . .	2
33	190004	EYE BOLT, Release Spring, 5/8 - 18 . . . . .	2
34	33947-S8	NUT, 5/8 - 18 Hex Jam . . . . .	4
35	190008	SPACER, Eye Bolt . . . . .	2
36	190007	ROD, Anchor Eye Bolt . . . . .	2
37	72075-S8	PIN, 1/4 x 1-1/2 Cotter - Anchor Rod . . . . .	4
38	304839-S36	BOLT, 5/8 - 18 x 2 Hex Hd.) Toggle Bar to Blade	2
39	33850-S36	NUT, 5/8 - 18 Hex )	2

# BLADES

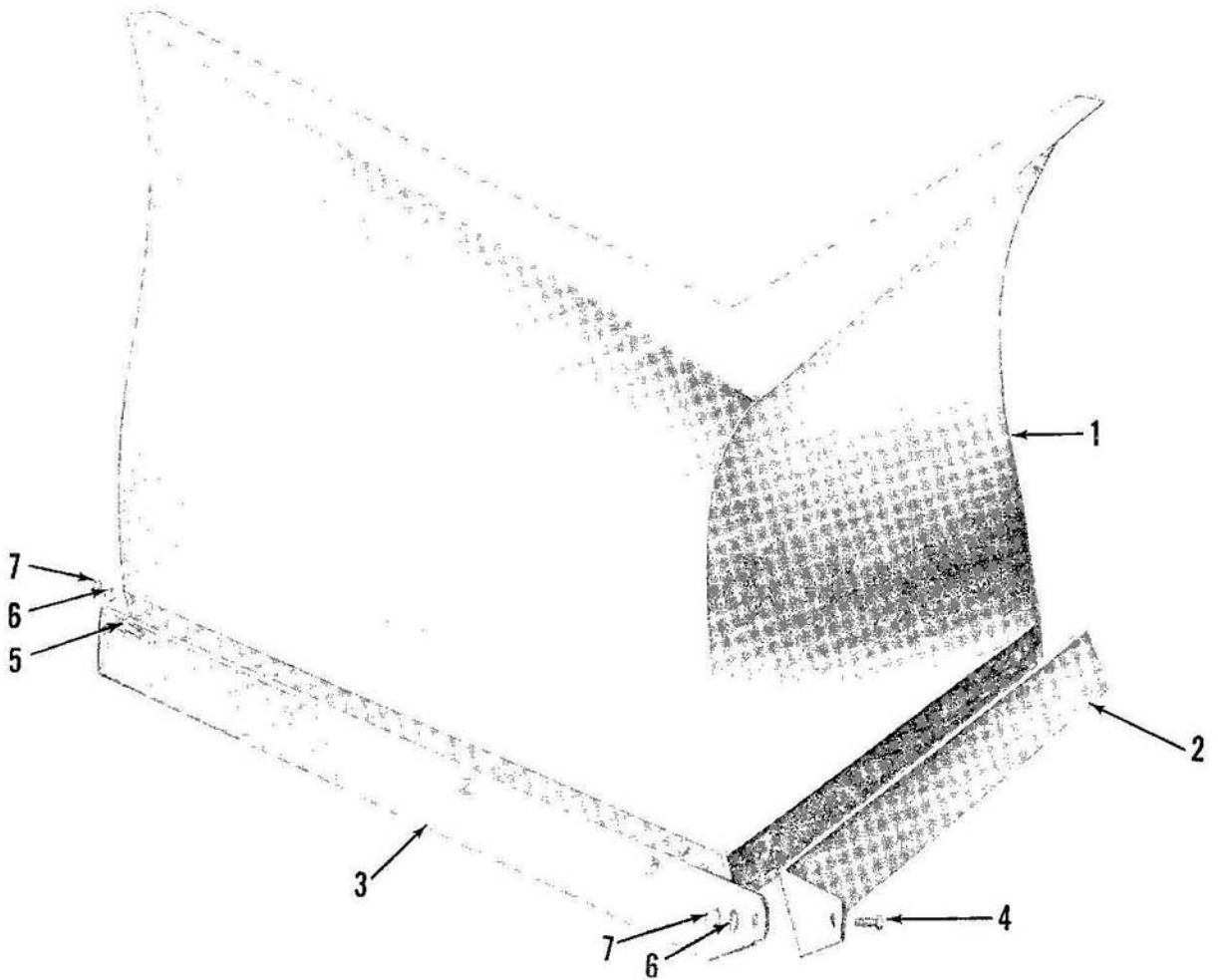
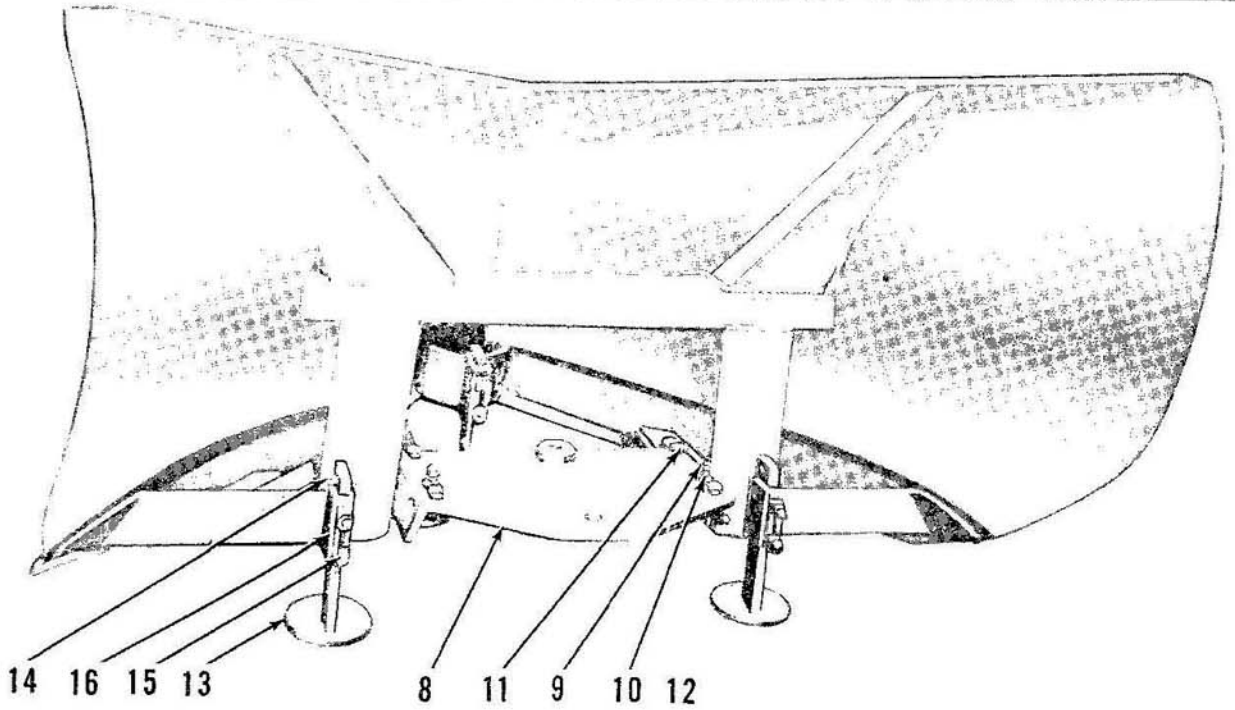

Fig. 10 - "V" Snow Plow Blade

# BLADES

FIG.	PART NO.	NAME AND DESCRIPTION	QTY. REQ.
10		<u>GROUP 3-3 "V" SNOW PLOW BLADE MODEL 19-4</u>	<u>19-4</u>
1	N.S.	BLADE ASSEMBLY . . . . .	1
2	190220	LIP, Cutting, Left . . . . .	1
3	190221	LIP, Cutting, Right . . . . .	1
4	303338-S8	BOLT, 1/2 - 13 x 1-1/4 Plow)	1
5	300308-S8	BOLT, 1/2 - 13 x 1-1/2 Plow) Lip to Blade	8
6	34809-S36	WASHER, 1/2 Lock )	9
7	33845-S8	NUT, 1/2 - 13 Hex )	9
8	190243	PLATE ASSY, Adapter . . . . .	1
9	91498-S34	SET SCREW, 5/8-11 x 1-3/4 Sq. Hd. Cup Pt.) Plate	2
10	33946-S8	NUT, 5/8 - 11 Hex Jam ) Adjusting	2
11	304805-S36	BOLT, 5/8 - 18 x 1-3/4 Hex Hd.)	2
12	304869-S36	BOLT, 5/8 - 18 x 2-1/4 Hex Hd.) Plate to Blade Base	2
—	34811-S7	WASHER, 5/8 Lock )	4
—	33850-S36	NUT, 5/8 - 18 Hex )	4
13	190034	SHOE, Skid . . . . .	3
14	72075-S8	PIN, 1/4 x 1-1/2 Cotter . . . . .	3
15	91251-S34	SET SCREW, 1/2-13 x 1-3/4 Sq. Hd. Cup Pt.) Skid Shoe	6
16	33845-S8	NUT, 1/2 - 13 Hex Jam )	6

# BLADES

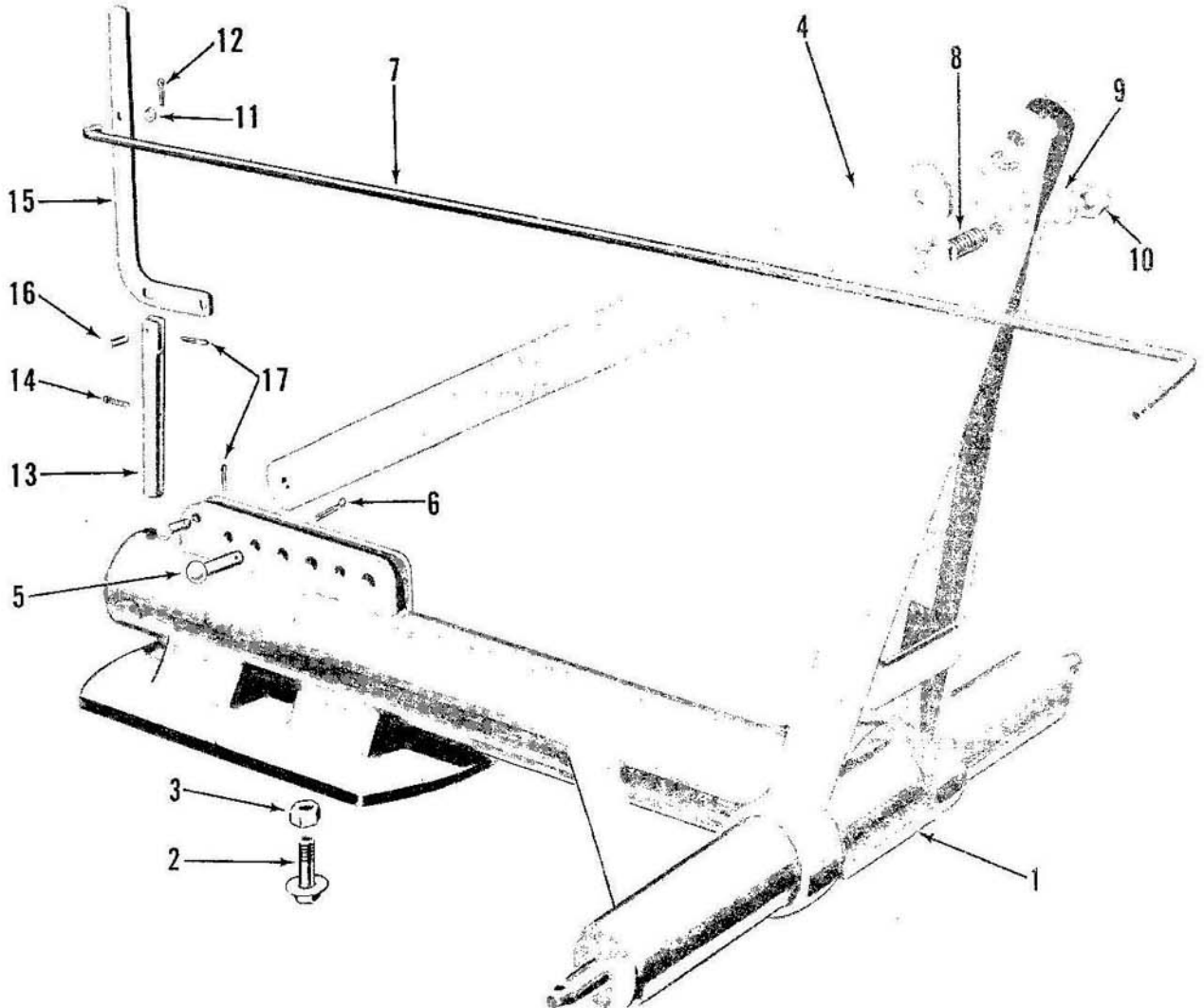

Fig. 11 - Frame Assembly 19-5

FIG.	PART NO.	NAME AND DESCRIPTION	QTY. REQ.
<b>11</b>		<b>GROUP 4-1 FRAME ASSEMBLY - MODEL 19-5</b>	<b>19-5</b>
1	N.S.	FRAME ASSEMBLY (Repair Locally)	1
2	190178	BOLT, 5/8-18 x 2 Hex Hd. W/Washer) Pivot & Blade to	1
3	33850-S36	NUT, 5/8 - 18 Hex ) Frame	1
4	190174	BAR, Pitch Regulating	1
5	191741	RIVET, 5/8 x 1-3/4 Rd. Hd. Drilled) Pitch Bar to	1
6	72073-S8	PIN, 3/16 x 1-1/2 Cotter ) Frame	1
7	N.S.	ROD, Pull (Procure Locally)	1
8	N.S.	BOLT, 5/8 - 18 x 2-1/4 W/Clip Welded)	1
9	34811-S36	WASHER, 5/8 Lock ) Pull Rod to	1
10	33850-S36	NUT, 5/8 - 18 Hex ) "A" Frame	1
11	44728-S36	WASHER, 3/8 Flat )	1
12	72035-S8	PIN, 1/8 x 1 Cotter) Pull Rod to Lever	1
13	190172	PIN, Lock	1
14	72073-S8	PIN, 3/16 x 1-1/2 Cotter	1
15	190171	LEVER, Lift-Lock Pin	1
16	352594-S	PIN, 3/8 x 1-5/16 Clevis, Lift Lever) Lever to Pin	2
17	72035-S8	PIN, 1/8 x 1 Cotter ) to Frame	2



# BLADES

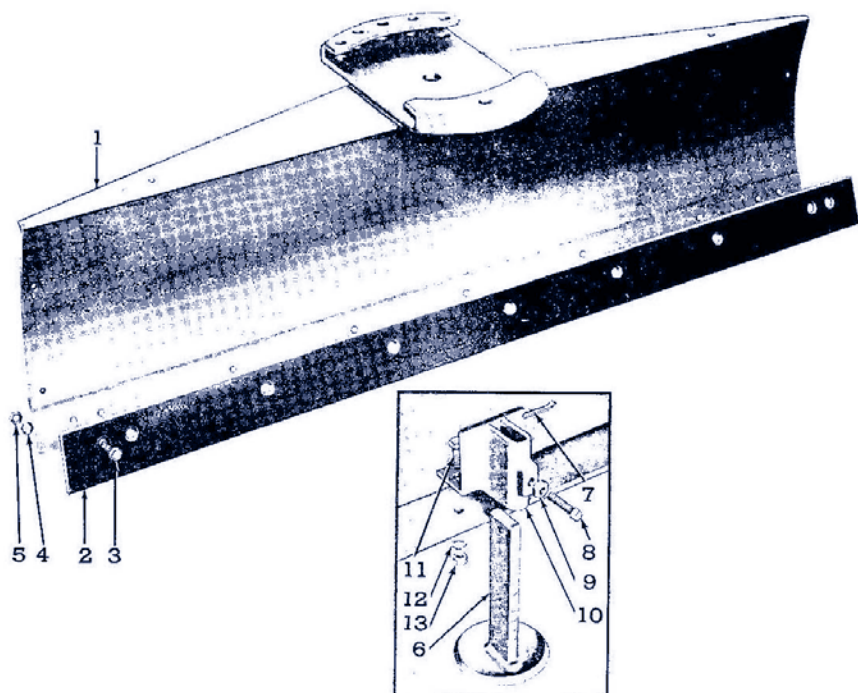

Fig. 12 - Blade Assembly With Skid Shoes 19-5

FIG.	PART NO.	NAME AND DESCRIPTION	QTY. REQ.
12		<u>GROUP 4-2 - BLADE ASSEMBLY MODEL 19-5</u>	19-5
1	N.S.	BLADE ASSEMBLY . . . . .	1
2	190200	LIP, Cutting . . . . .	1
3	300308-S8	BOLT, 1/2 - 13 x 1-1/2 Plow)	9
4	34809-S36	WASHER, 1/2 Lock ) Edge to Blade	9
5	33845-S8	NUT, 1/2 - 13 Hex Jam )	9
-	<u>190033</u>	<u>KIT, Skid Shoe &amp; Bracket</u> . . . . .	AR
		Consists of:	
6	190034	SHOE, Skid . . . . .	2
7	72057-S8	COTTER PIN, 1/4 x 1-1/4 )	2
8	91476-S	SET SCREW, 1/2-13 x 1-1/2 Sq Hd Cup Pt.) Skid Shoe	2
9	33942-S8	NUT, 1/2 - 13 Hex Jam )	2
10	190062	BRACKET, Mounting . . . . .	2
11	304765-S36	BOLT, 1/2 - 20 x 1-1/2 Hex Hd.)	4
12	34809-S36	WASHER, 1/2 Lock ) Bracket to Blade	4
13	33846-S8	NUT, 1/2 - 20 Hex )	4

# BLADES

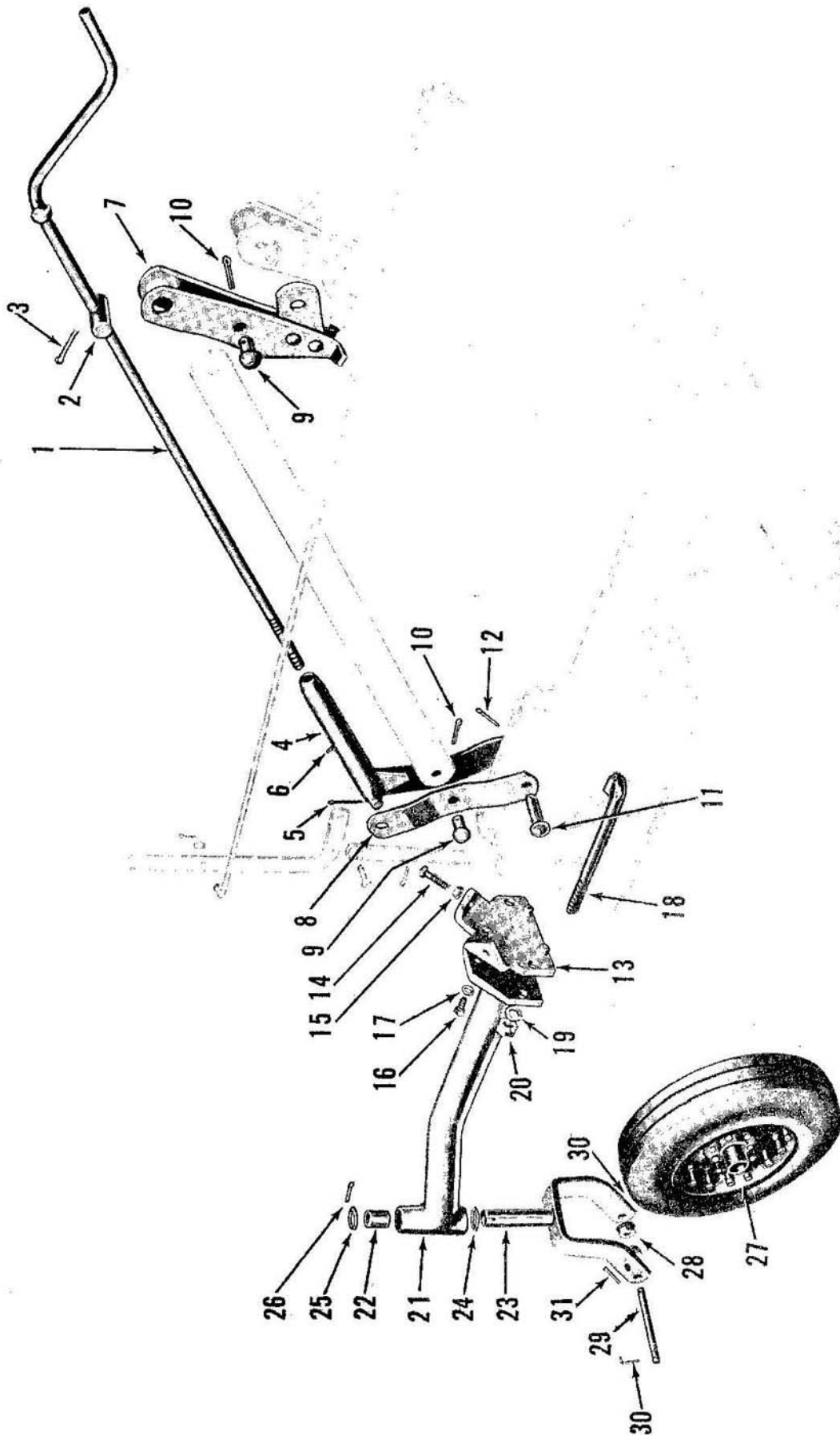

Fig. 13 - Gauge Wheel Attachment Model 19-19

# BLADES

FIG.	PART NO.	NAME AND DESCRIPTION	QTY. REQ.
13		<u>GROUP 5-1 - GAUGE WHEEL ATTACHMENT MODEL 19-19</u>	19-19
1	191239	CRANK ASSEMBLY . . . . .	1
2	191231	BLOCK, Thrust . . . . .	1
3	72073-S8	PIN, 3/16 x 1-1/2 Cotter - Block to Bracket . . .	2
4	N.S.	CRANK NUT & SLEEVE ASSY, Depth Adjusting . . . . .	1
5	72073-S8	PIN, 3/16 x 1-1/2 Cotter - Sleeve to Crank Bracket	1
6	87901-S8	FITTING, Lube, 1/8 - 27 x 3/4 - Straight . . . . .	1
7	191227	BRACKET ASSY, Crank Thrust . . . . .	1
8	191241	BRACKET, Crank . . . . .	2
9	191741	PIN, 5/8 x 1-3/4 Rd. Hd. Drld.)	2
10	72073-S8	PIN, 3/16 x 1-1/2 Cotter ) Pitch Bar to Brackets	2
11	74074-S34	PIN, 5/8 x 2-1/4 Button Hd.) Crank Brackets to	1
12	72073-S8	PIN, 3/16 x 1-1/2 Cotter ) Adj. Rack	1
13	191222	BRACKET, Adapter . . . . .	1
14	91476-S34	SET SCREW, 1/2 - 13 x 1-1/2 Sq. Hd.)	2
15	33942-S8	NUT, 1/2 - 13 Hex Jam ) Adapter Bracket	2
16	375571-S8	BOLT, 1/2 - 20 x 1-1/4 Hex Hd.)	1
17	34809-S36	WASHER, 1/2 Lock ) Bracket to Support	1
18	191225	BOLT, Hook, 5/8 - 18 x 9-3/4 . . . . .	2
19	34811-S7	WASHER, 5/8 Lock )	2
20	33850-S36	NUT, 5/8 - 18 Hex) Hook Bolt to Support	2
21	N.S.	SUPPORT ASSY, Gauge Wheel . . . . .	1
		Consists of Support Plus:	
22	191216	BEARING, Oilite, Spindle . . . . .	2
-	72073-S8	FITTING, Lube, 1/8 - 27 x 3/4 - Straight . . . . .	1
23	191218	FORK ASSY, Gauge Wheel . . . . .	1
24	191320	WASHER, Thrust, Spindle (Brass) . . . . .	1
25	44759-S8	WASHER, Spindle (Steel) . . . . .	1
26	72111-S8	PIN, 1/4 x 2" Cotter - Fork Spindle . . . . .	1
27	191245	WHEEL, Gauge 4:00 x 8, Less Tire . . . . .	1
28	191247	BEARING, Oilite, Gauge Wheel . . . . .	2
29	191248	AXLE, Gauge Wheel . . . . .	1
30	191249	RETAINER, Gauge Wheel Axle . . . . .	1
31	72073-S8	PIN, 3/16 x 1-1/2 Cotter - Gauge Wheel Axle . . .	1

# BLADES

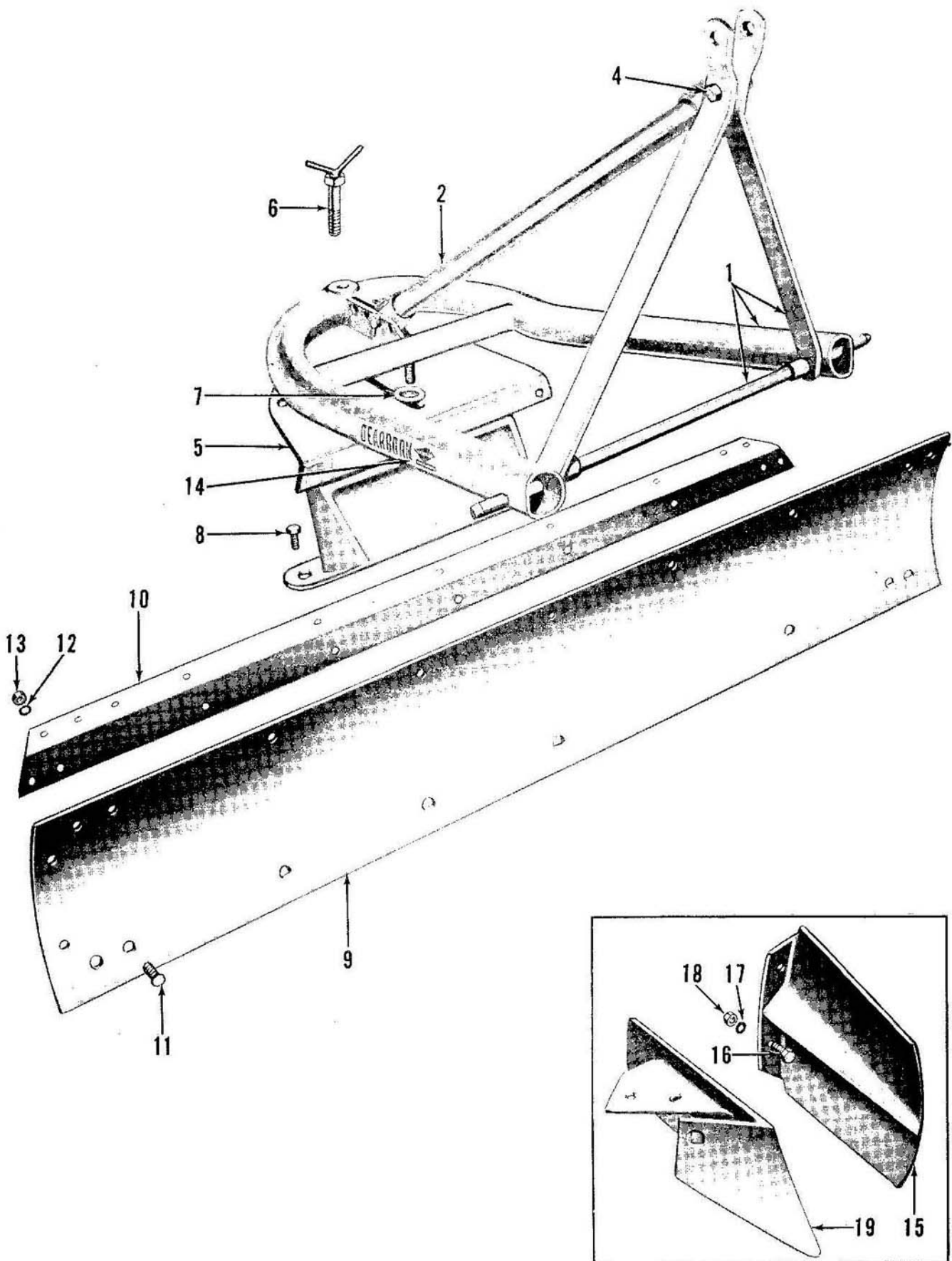
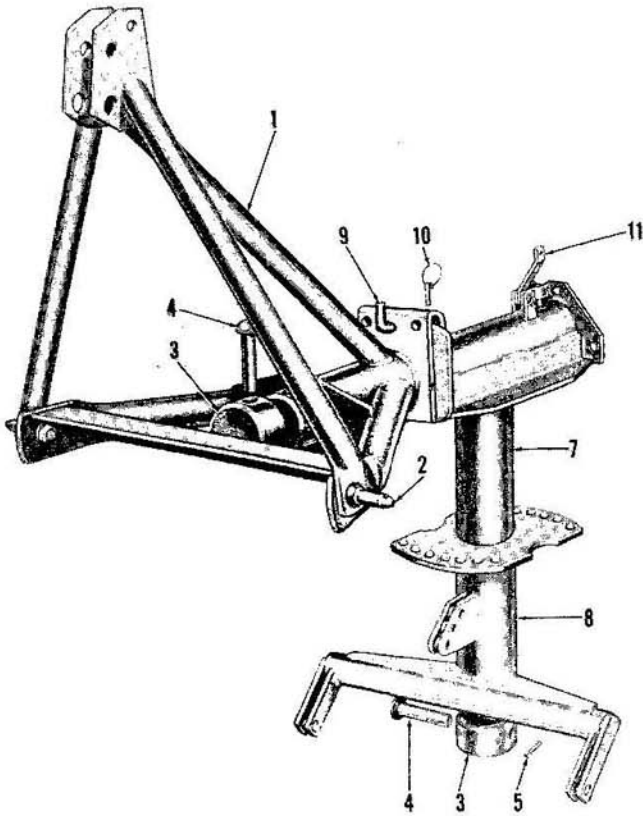

Fig. 14 - Frame, Blade & Attachments 19-72

# BLADES

FIG.	PART NO.	NAME AND DESCRIPTION	QTY. REQ.
14		<u>GROUP 6-1 FRAME, BLADE &amp; ATTACHMENTS - MODEL 19-72</u>	19-72
1	194610	FRAME ASSEMBLY . . . . .	1
2	194626	BAR, Pitch . . . . .	1
3	74004-S8	PIN, 5/8 x 1-13/16 Clevis)	1
-	72055-S8	PIN, 3/16 x 1-1/4 Cotter ) Pitch Bar to Frame	1
4	304838-S36	BOLT, 5/8 - 11 x 2 Hex Hd.)	1
-	34811-S36	WASHER, 5/8 Lock ) Pitch Bar to Frame	1
-	33849-S36	NUT, 5/8 - 11 Hex )	1
5	194617	TURNTABLE ASSEMBLY . . . . .	1
6	194622	BOLT ASSY, 1 - 8 Wing )	1
-	194624	NUT ASSY, 1 - 8 )	1
7	103006	WASHER, 1" Flat ) Frame to Turntable	1
-	370341-S8	NUT, 1 - 14 Slotted Hex)	1
-	72109-S8	PIN, 3/16 x 2 Cotter )	1
8	304768-S36	BOLT, 5/8 - 11 x 1-1/2 Hex Hd.)	2
-	34811-S36	WASHER, 5/8 Lock ) Turntable to Rein-	2
-	33849-S36	NUT, 5/8 - 11 Hex ) forcing Angle	2
9	194628	BLADE, Economy . . . . .	1
10	194629	ANGLE, Reinforcing . . . . .	1
11	300308-S8	BOLT, 1/2 - 13 x 1-1/2 Plow)	11
12	34809-S36	WASHER, 1/2 Lock ) Blade to Reinforcing	11
13	33845-S8	NUT, 1/2 - 13 Hex ) Angle and Turntable	11
14	H.S.	DECAL, Dearborn Equipment, 4 x 23-1/4 . . . . .	1
15	194776	<u>SIDE PLATES (Set of 2)</u> . . . . .	1
16	304726-S36	BOLT, 1/2 - 13 x 1-1/4 Hex Hd.)	4
17	34809-S36	WASHER, 1/2 Lock ) Side Plates to Blade	4
18	33845-S8	NUT, 1/2 - 13 Hex )	4
19	194775	<u>POINT, Ditching</u> . . . . .	1
--	304800-S36	BOLT, 1/2 - 13 x 1-3/4 Hex Hd.)	1
--	303338-S8	BOLT, 1/2 - 13 x 1-3/4 Plow )	1
--	44736-S8	WASHER, 1/2 Flat ) Point to Blade	1
--	34809-S36	WASHER, 1/2 Lock )	2
--	33845-S8	NUT, 1/2 - 13 Hex )	2
--	304804-S36	BOLT, 5/8 - 11 x 1-3/4 Hex Hd.)	1
--	44744-S8	WASHER, 5/8 Flat )	1
--	34811-S36	WASHER, 5/8 Lock ) Point to Blade	1
--	33849-S36	NUT, 5/8 x 11 Hex )	1

# BLADES



(19-85)

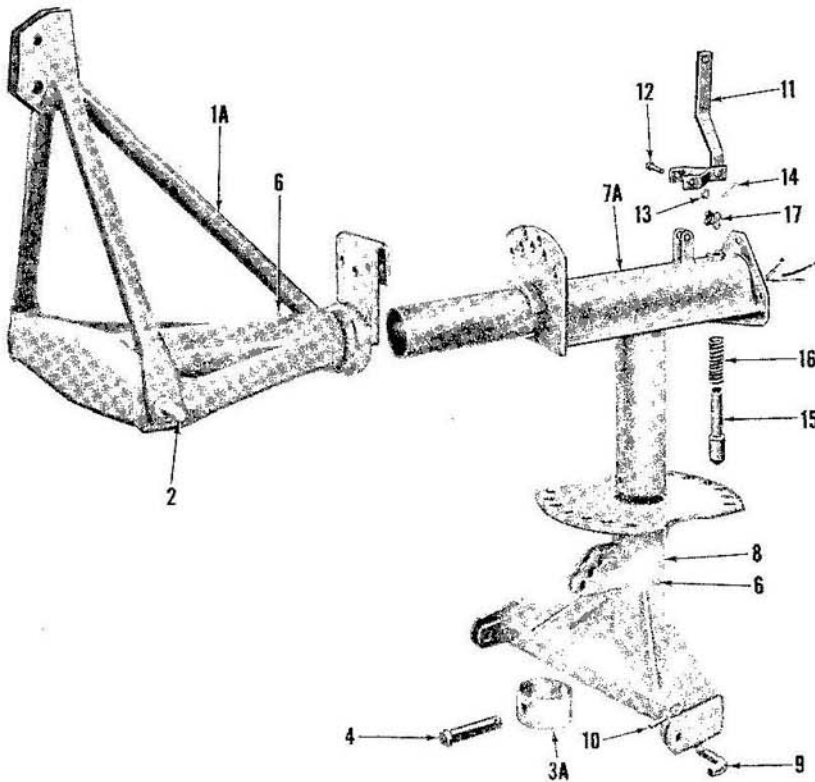

(19-205)

Fig. 15 - Frame & Turntable Parts 19-85,205

# BLADES

FIG.	PART NO.	NAME AND DESCRIPTION	QTY.	REQ.
<u>GROUP 7-1 FRAME &amp; TURNTABLE PARTS</u>			19-19-	
<u>MODELS 19-85 &amp; 205</u>			85205	
1	197644	FRAME ASSY, Rear Blade . . . . .	1	-
1A	196265	FRAME ASSY, Rear Blade . . . . .	-	1
2	133687	PIN, Link 7/8 - 14 Cat. I . . . . .	2	-
2	109741	PIN, Link 7/8 - 14 Cat. I . . . . .	-	2
-	34814-S8	WASHER, 7/8 Lock ) Link Pin to Frame	2	2
-	34677-S8	NUT, 7/8 - 14 Hex)	2	2
-	222291	PIN, Link Cat. II . . . . .	2	-
-	104434	PIN, Link Cat. II . . . . .	-	2
3	194829	COLLAR ASSY, Thrust . . . . .	2	-
3A	193624	COLLAR ASSY, Thrust . . . . .	-	1
4	194184	PIN, 1 x 5-1/8 Clevis )	2	1
5	72075-S8	PIN, 1/4 x 1-1/2 Cotter) Retain Collar	2	1
-	87934-S8	FITTING, 5/16 x 19/32 Lube . . . . .	2	-
6	87907-S8	FITTING, 1/4 - 28 x 1/2 Lube Str. . . . .	-	2
7	194790	TUBE ASSY, Turntable . . . . .	1	-
7A	196267-	TUBE ASSY, Turntable . . . . .	-	1
8	198557	SLEEVE ASSY, Turntable . . . . .	1	1
9	194815	PIN, 3/4 Pull ) Frame to Tube (1 Reg.)	4	4
10	2N-608	LINCH PIN & LOCKING RING) Sleeve to Blade (3 Reg.)	4	4
11	195241	LIFTER ASSY, Pin . . . . .	1	1
12	74049-S8	PIN, 3/8 x 2-1/4 Clevis)	1	1
13	44726-S36	WASHER, 3/8 Flat ) Lifter to Bracket	1	1
14	72016-S8	PIN, 3/32 x 3/4 Cotter )	1	1
15	195239	PIN, Lifter . . . . .	1	1
16	195237	SPRING, Lifter Pin . . . . .	1	1
17	164127	LINK ASSY, 1" Pitch #80 Chain . . . . .	1	1
--	305225	DECAL, "Ford" I.D. 1-13/16 x 5-17/32 . . . . .	1	1
--	150605	DECAL, Series Blank . . . . .	-	1
--	150585	DECAL, Series #7 . . . . .	-	1
--	150591	DECAL, Series #1 . . . . .	-	1
--	150592	DECAL, Series #0 . . . . .	-	1

# BLADES

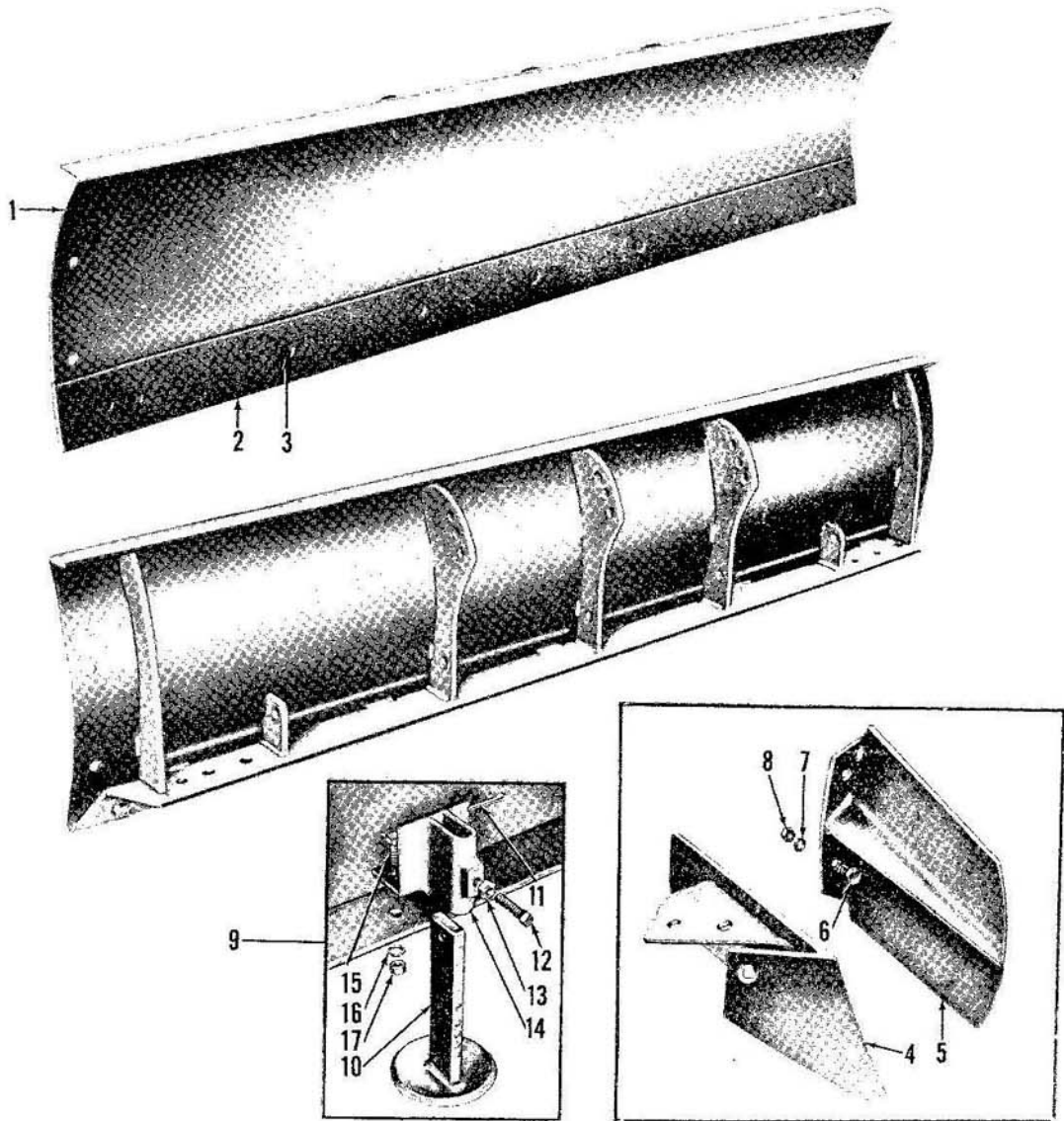

Fig. 16 - Blade Assembly

FIG.	PART NO.	NAME AND DESCRIPTION	QTY. REQ.
16		<u>GROUP 7-2 BLADE ASSY, ADJUSTABLE REAR</u> <u>MODELS 19-85 &amp; 205</u>	19-85, 205
1	194810	BLADE ASSY, 6' . . . . .	1
2	194827	LIP, Cutting . . . . .	1
3	300308-S8	BOLTS, 1/2 - 13 x 1-1/2 Plow)	9
-	34809-S36	WASHER, 1/2 Lock ) Lip to Blade	9
-	33845-S8	NUT, 1/2 - 13 Hex Jam )	9



# BLADES

FIG.	PART NO.	NAME AND DESCRIPTION	QTY. REQ.
16		<u>GROUP 7-2 BLADE ASSY, ADJUSTABLE REAR</u> <u>MODELS 19-85 &amp; 205 (CONT'D)</u>	19- 85, 205
4	<u>194775</u>	<u>POINT ASSY, Ditching</u> . . . . .	AR
-	304800-S36	BOLT, 1/2 - 13 x 1-3/4 Hex Hd.)	1
-	303686-S8	BOLT, 1/2 - 13 x 1-3/4 Plow )	1
-	304804-S36	BOLT, 5/8 - 11 x 1-3/4 Hex Hd.)	1
-	44736-S8	WASHER, 1/2 Flat )	2
-	34809-S36	WASHER, 1/2 Lock ) Point to Blade	2
-	44744-S8	WASHER, 5/8 Flat )	1
-	34811-S7	WASHER, 5/8 Lock )	1
-	33845-S8	NUT, 1/2 - 13 Hex )	2
-	33849-S36	NUT, 5/8 - 11 Hex )	1
5	<u>194776</u>	<u>SIDE PLATES (Set of Two)</u> . . . . .	AR
6	304726-S36	BOLT, 1/2 - 13 x 1-1/4 Hex Hd.)	4
7	34809-S36	WASHER, 1/2 Lock ) Side Plates to Blade	4
8	33845-S8	NUT, 1/2 - 13 Hex )	4
9	<u>190033</u>	<u>KIT, Skid Shoe &amp; Bracket</u> . . . . .	AR
		Consists of:	
10	190034	SHOE, Skid . . . . .	2
11	72057-S8	PIN, 1/4 x 1-1/4 Cotter . . . . .	2
12	91476-S	SET SCREW, 1/2-13 x 1-1/2 Sq Hd Cup Pt.) Shoe to	2
13	33942-S8	NUT, 1/2 - 13 Hex Jam ) Bracket	2
14	190062	BRACKET, Mounting . . . . .	2
15	304765-S36	BOLT, 1/2 - 20 x 1-1/2 Hex Hd.)	4
16	34809-S36	WASHER, 1/2 Lock ) Bracket to Blade	4
17	33846-S8	NUT, 1/2 - 20 Hex )	4

# BLADES

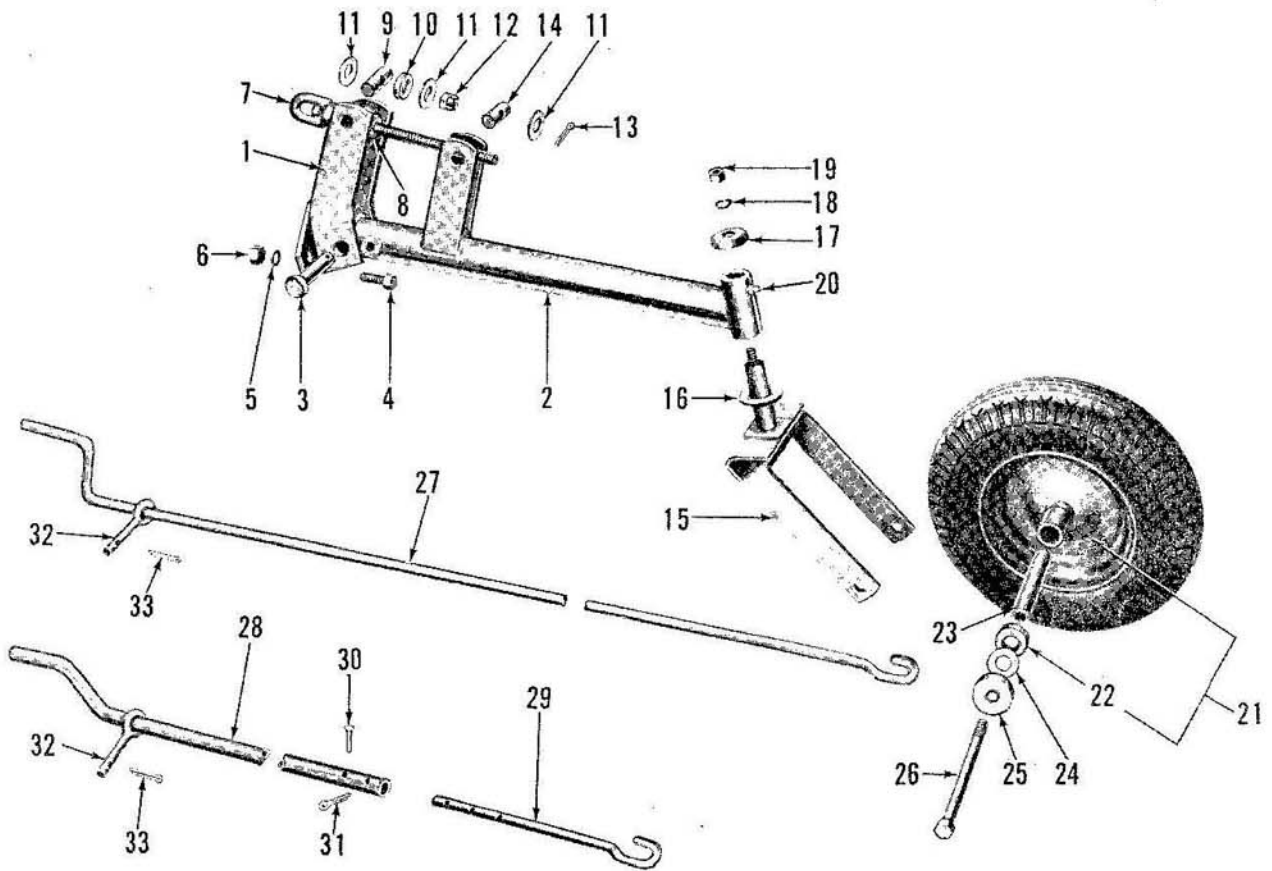

Fig. 17 - Gauge Wheel Attachment

FIG.	PART NO.	NAME AND DESCRIPTION	QTY. REQ.
17		<b>GROUP 8-1 GAUGE WHEEL ATTACHMENT</b> <b>MODELS 19-86 &amp; 189</b>	19-86, 189
1	195232	BRACKET ASSY, Gauge Wheel . . . . .	1
2	194596	ARM ASSY, Gauge Wheel . . . . .	1
3	106486	PIN, 7/8 x 4 Button Hd. Drilled) Bracket to Arm	1
-	72075-S8	PIN, 1/4 x 1-1/2 Cotter )	1
4	304768-S36	BOLT, 5/8 - 11 x 1-1/2 Hex Hd.)	3
5	34811-S36	WASHER, 5/8 Lock ) Bracket to Tube	3
6	33849-S36	NUT, 5/8 - 11 Hex )	3
7	194590	SCREW ASSY, Gauge Wheel . . . . .	1
8	194588	SPACER, Gauge Screw . . . . .	1
9	194581	PIN, Gauge Screw Pivot . . . . .	1
10	194671	BEARING, Gauge Screw . . . . .	1
11	44746-S8	WASHER, 3/4 Flat )	3
12	45301-S8	NUT, 3/4 - 10 Hex Slotted) Retain Bearing & Spacer	1
13	72053-S8	PIN, 1/8 x 1-1/4 Cotter ) on Screw Assy.	2

# BLADES

FIG.	PART NO.	NAME AND DESCRIPTION	QTY. REQ.
17		<u>GROUP 8-1 GAUGE WHEEL ATTACHMENT</u> <u>MODELS 19-86 &amp; 189 (CONT'D)</u>	19- 86, 189
14	194587	PIN, Arm Adjusting . . . . .	1
15	220976	FORK ASSY, Gauge Wheel . . . . .	1
16	44761-S8	WASHER, 1-1/4 Flat . . . . .	1
17	220717	CAP, Dust . . . . .	1
18	34811-S36	WASHER, 5/8 Lock )	1
19	33849-S36	NUT, 5/8 - 11 Hex) Fork to Arm	1
20	87901-S8	FITTING, Lube 1/8 - 27 Str. . . . .	1
21	107846	WHEEL ASSEMBLY, Gauge 8" . . . . .	1
		Consists of Wheel Plus:	
22	107849	BEARING, Wheel . . . . .	2
23	144949	SPACER, .687 x 1 x 6-1/16 Tube . . . . .	1
24	147075	WASHER, Hub . . . . .	2
25	147077	CUP, Hub . . . . .	2
26	302609-S8	BOLT, 5/8 - 11 x 8 Hex Hd.)	1
—	34811-S36	WASHER, 5/8 Lock ) Wheel to Fork	1
—	33946-S8	NUT, 5/8 - 11 Hex Jam )	1
27	194591	CRANK, Gauge Screw (19-86 Only) . . . . .	1
28	196596	CRANK, Gauge Screw (19-189 Only) . . . . .	1
29	196595	HOOK, Gauge Screw Crank (19-189 Only) . . . . .	1
30	73902-S	PIN, 3/16 x 1 Clevis )	2
31	72003-S8	PIN, 1/16 x 3/8 Cotter) Hook to Crank (19-189 Only)	2
32	196594	PIN, Eye . . . . .	1
33	72035-S8	PIN, 1/8 x 1 Cotter . . . . .	1

# BLADES

## NUMERICAL INDEX

2N-608 . . . . . 7,29	190166 . . . . . 19	194596 . . . . . 32
103006 . . . . . 27	190171 . . . . . 22	194610 . . . . . 27
104434 . . . . . 29	190172 . . . . . 22	194617 . . . . . 27
106486 . . . . . 32	190174 . . . . . 22	194622 . . . . . 27
107557 . . . . . 8	190178 . . . . . 22	194624 . . . . . 27
107846 . . . . . 33	190200 . . . . . 17,19,23	194626 . . . . . 27
107849 . . . . . 33	190220 . . . . . 21	194628 . . . . . 27
107962 . . . . . 11,13	190221 . . . . . 21	194629 . . . . . 27
109741 . . . . . 29	190243 . . . . . 21	194663 . . . . . 8
133687 . . . . . 29	191166 . . . . . 19	194669 . . . . . 11,12
141661 . . . . . 14,15	191216 . . . . . 25	194669 . . . . . 11,12
144949 . . . . . 33	191218 . . . . . 25	194671 . . . . . 32
147075 . . . . . 33	191222 . . . . . 25	194677 . . . . . 11
164127 . . . . . 29	191225 . . . . . 25	194678 . . . . . 11
190001 . . . . . 19	191227 . . . . . 25	194766 . . . . . 10
190002 . . . . . 19	191231 . . . . . 25	194769 . . . . . 8
190003 . . . . . 19	191239 . . . . . 25	194772 . . . . . 14,15
190004 . . . . . 19	191241 . . . . . 25	194775 . . . . . 27,31
190005 . . . . . 17,19	191245 . . . . . 25	194776 . . . . . 27,31
190006 . . . . . 17,19	191247 . . . . . 25	194790 . . . . . 29
190007 . . . . . 19	191248 . . . . . 25	194810 . . . . . 30
190008 . . . . . 19	191249 . . . . . 25	194815 . . . . . 29
190009 . . . . . 17,19	191320 . . . . . 25	194827 . . . . . 30
190010 . . . . . 19	191741 . . . . . 22,25	194829 . . . . . 29
190021 . . . . . 17,19	192114 . . . . . 11,13	195089 . . . . . 14
190028 . . . . . 19	192115 . . . . . 11,13	195095 . . . . . 14
190033 . . . . . 17,19,23,31	192128 . . . . . 11,13	195096 . . . . . 14
190034 . . . . . 17,19,21,23,31	193624 . . . . . 29	195097 . . . . . 14
190055 . . . . . 17	194011 . . . . . 7	195101 . . . . . 14
190062 . . . . . 17,19,23,31	194024 . . . . . 7	195211 . . . . . 9,11,13
190121 . . . . . 7	194035 . . . . . 7	195212 . . . . . 11
190122 . . . . . 6	194184 . . . . . 29	195232 . . . . . 32
190123 . . . . . 6	194283 . . . . . 7	195237 . . . . . 29
190124 . . . . . 6	194464 . . . . . 11,13	195239 . . . . . 29
190126 . . . . . 7	194466 . . . . . 11	195241 . . . . . 29
190151 . . . . . 7	194581 . . . . . 32	195363 . . . . . 11
190155 . . . . . 6	194587 . . . . . 33	195365 . . . . . 11,13
190157 . . . . . 6,8,9	194588 . . . . . 32	195367 . . . . . 8,9
190159 . . . . . 7	194590 . . . . . 32	195370 . . . . . 14,15
190162 . . . . . 7	194591 . . . . . 33	195581 . . . . . 14,15

# BLADES

## NUMERICAL INDEX

195582 . . . . .	14	196347 . . . . .	8	292044 . . . . .	9
195653 . . . . .	14	196594 . . . . .	33	292051 . . . . .	9
195654 . . . . .	14	196595 . . . . .	33	292061 . . . . .	13
195655 . . . . .	14	196596 . . . . .	33	292062 . . . . .	13
195656 . . . . .	14	196672 . . . . .	14,15	292063 . . . . .	12
195666 . . . . .	11,13	197644 . . . . .	29	292064 . . . . .	9
195668 . . . . .	11,12	198447 . . . . .	12	292071 . . . . .	15
195669 . . . . .	11,13	198557 . . . . .	29	292072 . . . . .	15
195675 . . . . .	11,12	199146 . . . . .	14,15	292074 . . . . .	15
196009 . . . . .	10,11	199147 . . . . .	8	292077 . . . . .	15
196265 . . . . .	29	220717 . . . . .	33	292097 . . . . .	15
196267 . . . . .	29	220976 . . . . .	33	292103 . . . . .	11,12
196346 . . . . .	11,13	222291 . . . . .	29	292332 . . . . .	15
				292333 . . . . .	15
				309594 . . . . .	11,13

# BLADES



## DECALS

<u>PART NO.</u>	<u>DESCRIPTION</u>	<u>PAGE NO.</u>
150585	Series #7	29
150591	Series #1	29
150592	Series #0	29
150605	Series Blank	29
305224	"Ford" I.D. 1-1/2 x 4-19/32 Script	8
305225	"Ford" I.D. 1-13/16 x 5-17/32 Script	9,11,13,29

This Catalog replaces the following Parts Catalogs:

PA-2434-A	Frames & Blades Series 705,709	October, 1962
PA-2434-A1	Supplement #1 Frames & Blades	June, 1965
PA-8272	Rear Adjustable Blade Series 710	September, 1960